

HP c7000 Server HW Expansion

Cloud Execution Environment

OPERATING INSTRUCTIONS

Copyright

© Ericsson AB 2016. All rights reserved. No part of this document may be reproduced in any form without the written permission of the copyright owner.

Disclaimer

The contents of this document are subject to revision without notice due to continued progress in methodology, design and manufacturing. Ericsson shall have no liability for any error or damage of any kind resulting from the use of this document.

Trademark List

All trademarks mentioned herein are the property of their respective owners. These are shown in the document Trademark Information.



Contents

1	Introduction	1
1.1	Scope	1
1.2	Prerequisites	1
1.2.1	Documents	1
1.2.2	Tools	1
1.2.3	Data	2
1.2.4	Conditions	2
2	Procedure	2
2.1	Adding a New Enclosure	3
2.2	Hardware Installation of the Server	3
2.2.1	Physical Installation of the Server	3
2.2.2	Configuring Server BIOS Settings	6
2.3	Concluding Routine	6





1 Introduction

The procedure described in this instruction is part of a complex procedure. Only perform the steps in this document if it is referred from another instruction or a work order is received.

The document provides hardware specific instructions on adding one or more servers as part of the region expansion of a version 1.1 HP c7000 based Cloud Execution Environment (CEE) with one or more Compute hosts.

1.1 Scope

This document describes how to add one or more new servers to an HP c7000.

1.2 Prerequisites

This section provides information on the documents, tools, and conditions that apply to the procedure.

1.2.1 Documents

Before starting this procedure, ensure that the following documents have been read and understood:

- *Personal Health and Safety Information*
- *System Safety Information*

The following documents are referred and used in this procedure:

- *HP c7000 Configuration*
- *HP c7000 Server BIOS Configuration*

The documents contain further prerequisites.

1.2.2 Tools

The following tools are needed:

- An Electrostatic Discharge (ESD) wrist strap (part number LYB 250 01/14)



1.2.3 Data

No data are needed.

1.2.4 Conditions

Before starting this procedure, ensure that the following conditions are met:

- A work order for the expansion is received or the document is referred from another procedure.
- The total number of existing and new servers does not exceed the maximum number of servers for the configuration.
- One of the following options is met:
 - a An unused slot for each new server is available.
 - b There are not enough unused slot or slots for the new server or servers and the following conditions are met:
 - The total number of existing and new enclosures does not exceed the maximum number of enclosures for the configuration.
 - The required number of new enclosures is available and it has been verified visually that the new enclosures are undamaged.
- The new server or servers are available and it has been verified visually that the new server or servers are undamaged.
- Cabling is done for the slot or slots in the existing enclosures to be used for the new server or servers according to the document *HP c7000 HW Installation*.
- All keys to the site are available and site access is granted.

2 Procedure

This procedure describes how to add one ore more servers.

The procedure contains the following activities:

1. Adding a new Enclosure, see Section 2.1 on page 3.



2. Hardware installation of the new server or servers, see Section 2.2 on page 3.
3. Concluding Routine, see Section 2.3 on page 6.

Start the procedure with the relevant section:

- If an unused slot for each new server is available in the existing enclosure or enclosures, start the procedure with Section 2.2 on page 3.
- Else, start the procedure with Section 2.1 on page 3.

2.1 Adding a New Enclosure

Do the following:

1. Add a new enclosure as described in *HP c7000 HW Installation*.
2. Continue with Section 2.2 on page 3.

2.2 Hardware Installation of the Server

Hardware installation of the server includes the following activities:

- Physical installation of the server or servers, see Section 2.2.1 on page 3.
- Configuration of server BIOS settings, see Section 2.2.2 on page 6.

Start the procedure with Section 2.2.1 on page 3.

2.2.1 Physical Installation of the Server

Do the following:

- 1 Inform the Operation and Maintenance Center (OMC) that work is in progress on the node, with possible disturbance to the service.



Warning!

High energy levels are present in this unit. Improper handling of the unit can lead to short circuits that can result in serious injury. Exercise care when working with this unit.

- 2 Locate the slot or slots where the new server or servers are to be installed.
- 3 Put the ESD wrist strap on your wrist and connect the cable to the grounding point.



Do!

Use an ESD wrist strap to avoid damage to components mounted on printed board assemblies.

- 4 Remove the server blank from the slot.

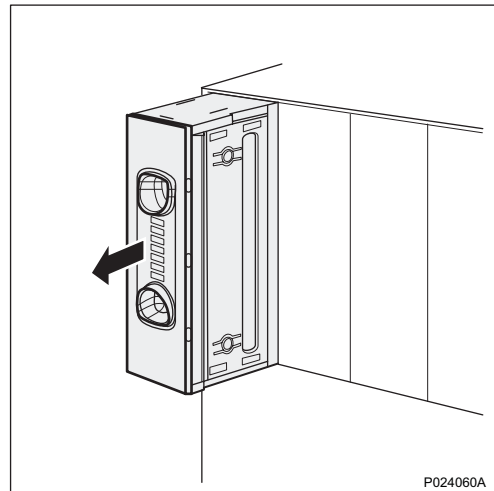

- 5 Remove the back connector cover from the server by pushing the release latch and pulling the cover.

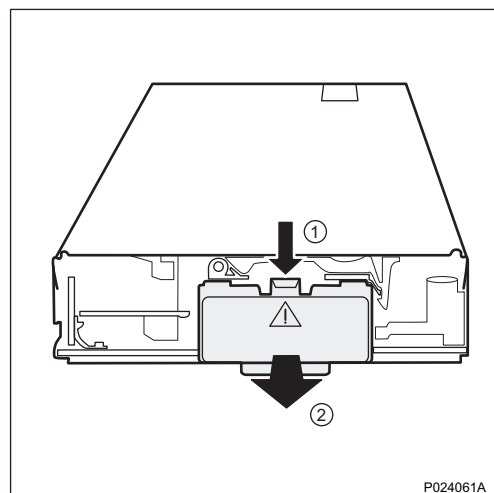



- 6 Insert and push the server into the slot carefully but stop before the server reaches the backplane.

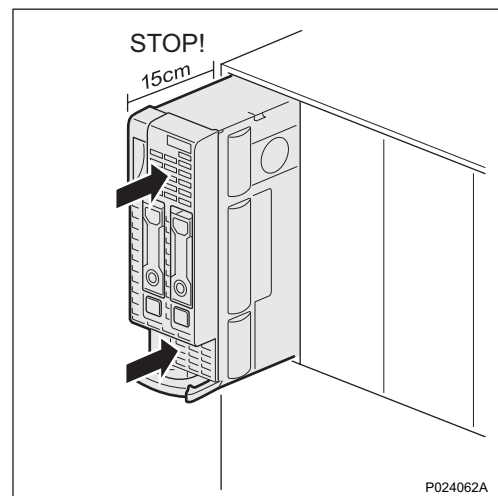

- 7 Open the latch by moving it to the right and open the handle.

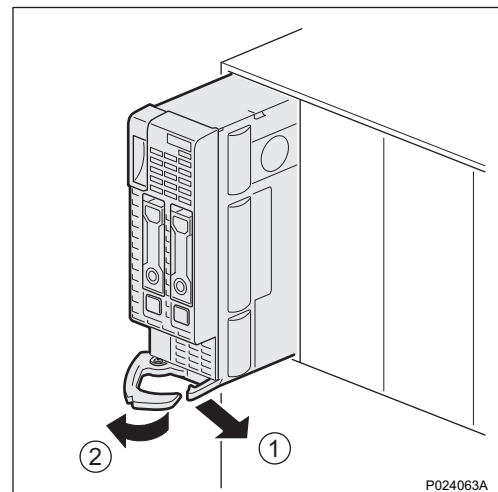

- 8 Push the server carefully to connect the backplane connector.

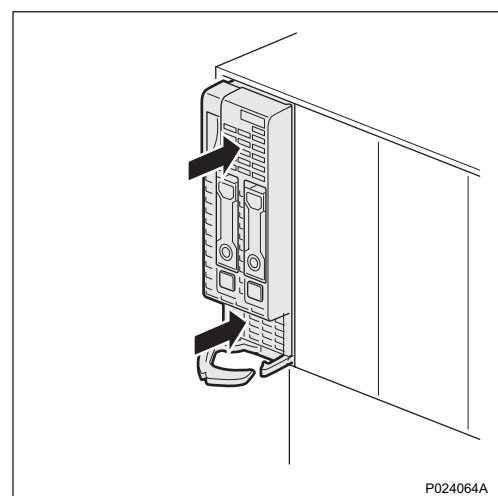

- 9 Shut the handle to fix the server in the slot. Ensure that the latch is closed.

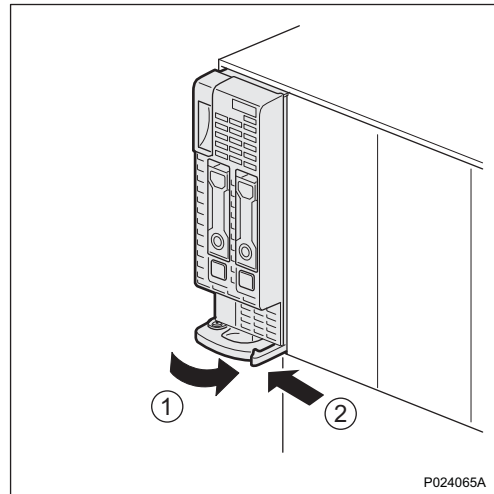

- 10 If there are further servers to install, repeat the above steps with the next server.
- 11 If a new enclosure or enclosures were installed, configure the new enclosure or enclosures as described in *HP c7000 Configuration*, including configuring the BIOS settings of the servers in the new enclosures.
- 12 Continue with Section 2.2.2 on page 6.

2.2.2 Configuring Server BIOS Settings

This section only concerns new servers installed in existing enclosures.

Note: The BIOS configuration of servers installed in new enclosures has already been done as part of enclosure configuration.

Do the following:

1. Refer to *HP c7000 Server BIOS Configuration* and perform the provided steps for configuring the HW settings.
2. Continue with Section 2.3 on page 6.

2.3 Concluding Routine

Do the following:

1. Collect all tools and equipment.
2. Report that the new server or servers have been physically added and the server BIOS settings have been configured.
3. Carry out any remaining actions according to the work order, if applicable.



4. If this document was referred from another instruction, get back to the referring procedure.
5. The job is completed.