

Engineer: Bruce Page	Date: 12/16/03	Raytheon JPS Communications 5800 Departure Drive, Raleigh, NC 27616			
Drawn: Bruce Page	Date: 12/18/03				
Approved: JAC	Date: 12/23/03	Title: ACU RADIO APPLICATION NOTES			
Issued/ Revised	Date: 4/15/04	Size: A	Dwg. #: 5961-271257-APP	Rev: A	Sheet: 1 Of 2

APPLIES TO:

Icom IC-A110 Mobile Radio

RADIO MODIFICATIONS:

A radio option cable must be installed per the Instruction Manual instructions for installation of the OPC 871 Headset Adaptor Option. After removal of DC power to the radio, unscrew the 4 screws and remove the bottom cover from the radio. The connector should be connected to the radio as shown below.

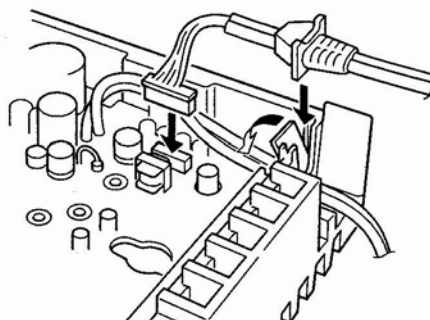

Bend the plastic dust cover before installing the strain relief into the notch.

RADIO PROGRAMMING:

1. Mobile radios should normally be programmed for low transmit power.

RADIO CONTROLS:

1. Adjust the Volume Control until the yellow "SIGNAL" indicator on the associated DSP Module flashes with receive audio.

CABLING:

Standard ACU-1000 and ACU-T Interface cables are made up of a 2 foot TRP Radio Tray Interface cable and the appropriate 13-foot Extension cable.

ACU-1000 Interface Cable	JPS P/N 5961-291257	(5961-271257 + 5961-261002-00)
ACU-T Interface Cable	JPS P/N 5961-281257	(5961-271257 + 5961-281013-00)
TRP-1000 Shelf Interface Cable	JPS P/N 5961-271257	
Radio RF Connector Type	UHF Female	

DSP PROGRAMMING:

RX Level	3*	0dBm*
TX Level	6*	0dBm*
Squelch Type	VOX*	
COR Polarity	Active Low*	
High Frequency Equalizer	4*	Flat*
RX Audio Delay	2*	100 ms*
TX Audio Delay (Radio Type)	0*	No Delay*
Noise Reduction Value	0*	Off*
VOX/VMR Threshold	1*	Med1*
VOX/VMR Hang Time	3*	775 ms*
COR Inhibit After PTT	1*	100 ms*
All Others	As needed	

(* Indicates Default Value)

NOTES:

PURCHASED PART

Rev	ECO	Date
A		

MAKE FROM ICOM OPC-871 HEADSET ADAPTER
(JPS P/N 0150-200003)

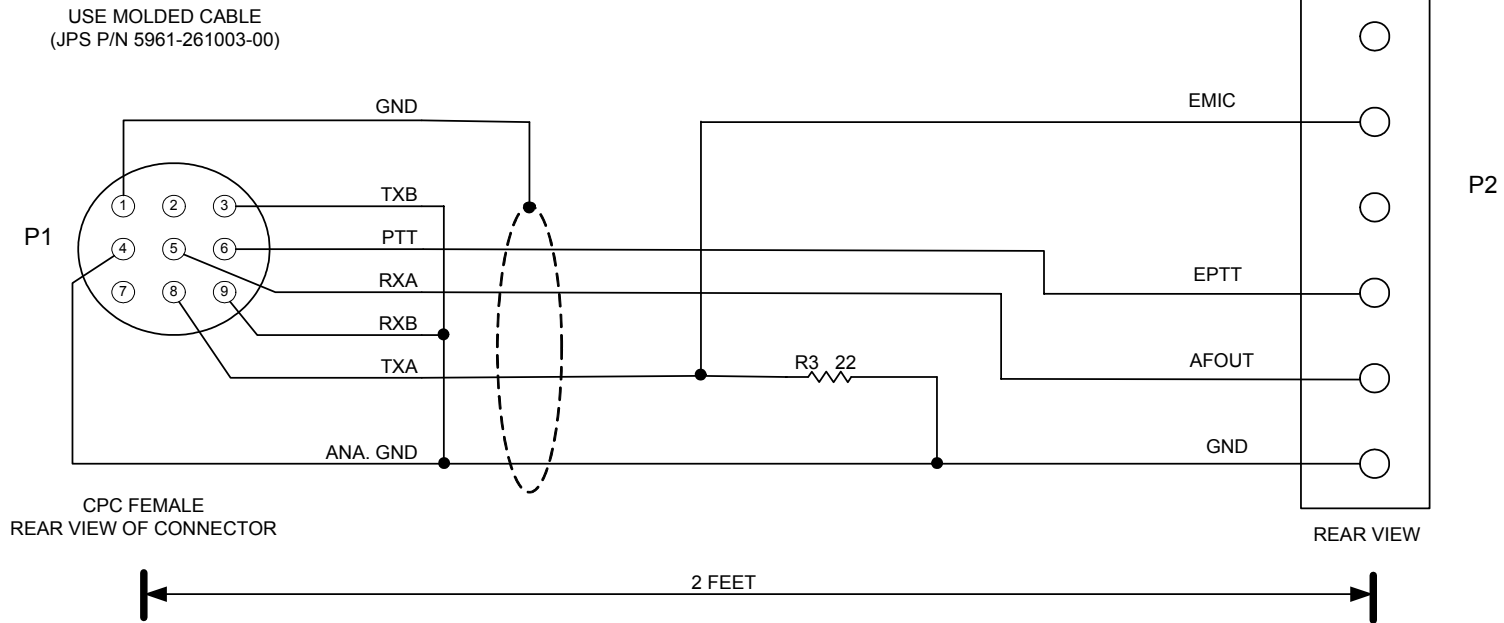

COMPONENT PCB
(JPS P/N 5961-271000)

R3 JPS P/N 1820-220000
JU1
JU2
JU4
JU5
JU6

USED WITH:
ICOM IC-A110 MOBILE

NOTE: SHIELD DRAIN CONNECTED TO PIN 1 OF P1 ONLY.

Designed By: RBP	Raytheon JPS Communications		
Drawn By: RBP	Title CABLE, ACU TO ICOM IC-A110 MOBILE		
Checked By: JAC	Size A	Document Number 5961-271257	Rev A
Issued Date		DECEMBER 18, 2003	Sheet <u>1</u> of <u>1</u>

PURCHASED PART

Rev	ECO	Date
A		

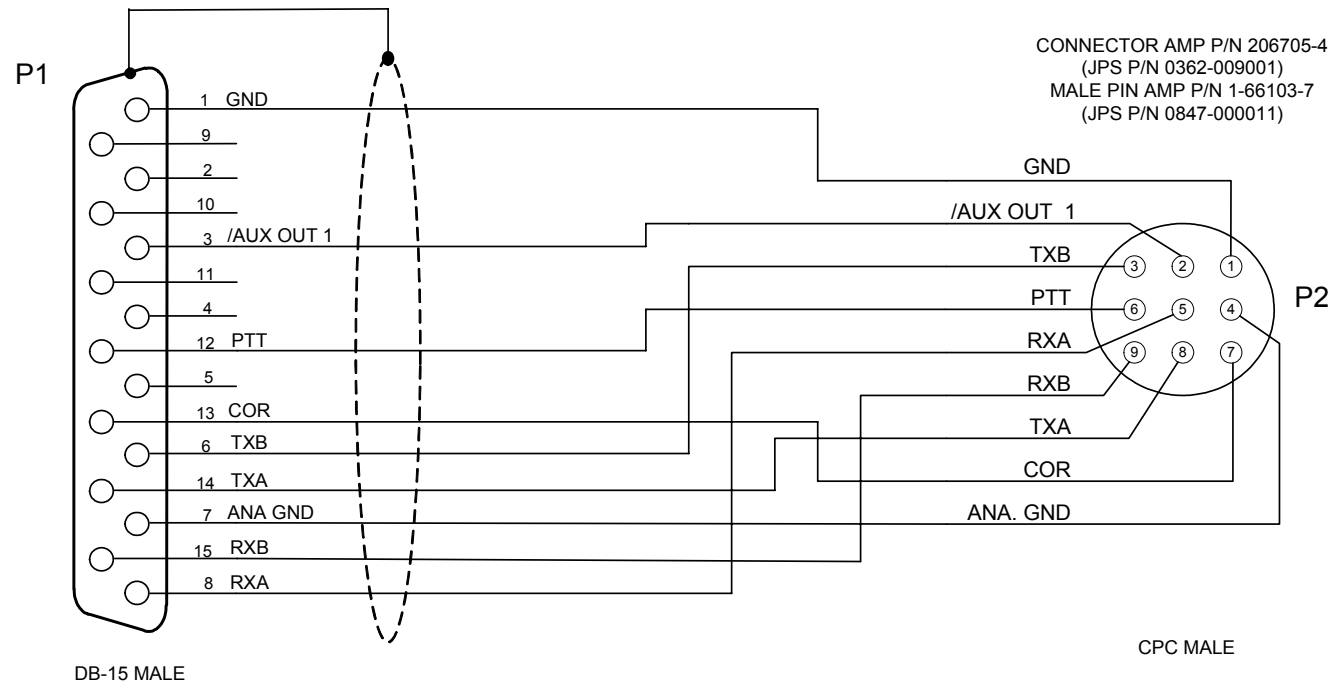

- NOTES: 1) USE BELDEN 9934 SHIELDED CABLE.
2) CONNECT SHIELD DRAIN TO SHELL OF P1 ONLY.
3) CONNECTORS P1 AND P2 MUST BE MOLDED TO THE CABLE.
4) CABLE MUST BE LABELED WITH THE RAYTHEON/JPS P/N AND REV, VENDOR CODE AND DATE (MM/YY).

Designed By: JAC	Raytheon JPS Communications		
Drawn By: JAC	Title CABLE, ACU-1000 RADIO EXTENSION - 13 FT		
Checked By: RBP	Size A	Document Number 5961-261002-00	Rev A
Issued Date JANUARY 5, 2004		Sheet <u>1</u> of <u>1</u>	

Rev	ECO	Date
A		

PURCHASED PART

CONNECTOR AMP P/N 206708-1
(JPS P/N 0362-005003)
FEMALE PIN AMP P/N 1-66105-8
(JPS P/N 0362-005002)

CONNECTOR AMP P/N 206705-4
(JPS P/N 0362-009001)
MALE PIN AMP P/N 1-66103-7
(JPS P/N 0847-000011)

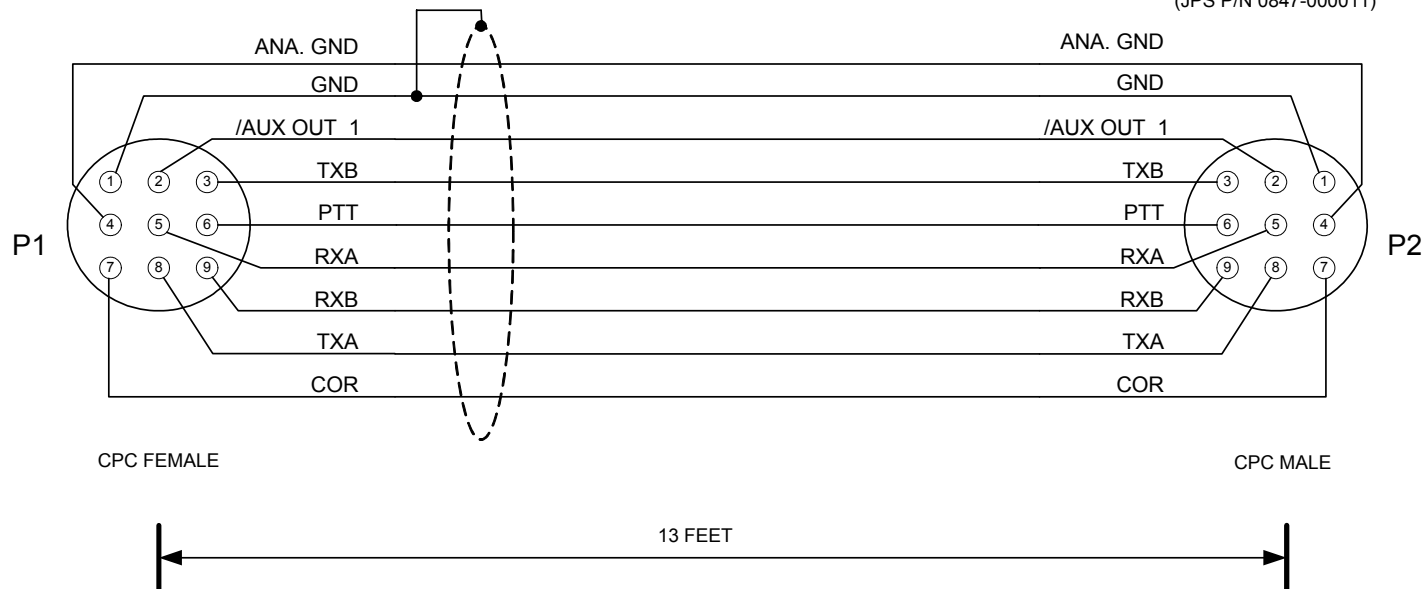

- NOTES: 1) USE BELDEN 9934 SHIELDED CABLE.
2) CONNECT SHIELD DRAIN TO PIN 1 OF P1 ONLY.
3) CONNECTORS P1 AND P2 MUST BE MOLDED TO THE CABLE.
4) CABLE MUST BE LABELED WITH THE RAYTHEON/JPS P/N AND REV, VENDOR CODE AND DATE (MM/YY).

Designed By: JAC	Raytheon JPS Communications Raleigh, NC USA		
Drawn By: JAC	Title CABLE, ACU-T RADIO EXTENSION - 13 FT		
Checked By: RBP	Size A	Document Number 5961-281013-00	Rev A
Issued Date JANUARY 5, 2004		Sheet <u>1</u> of <u>1</u>	