

# Quick Install Guide

## PowerLine AV Wireless N Extender



Thank you for purchasing the PowerLine AV Wireless N Extender. Follow the easy steps in this guide to properly set up your Adapter. Please verify that all of the package contents listed below are available.

### Package Contents



One D-Link DHP-W306AV PowerLine AV Wireless N Extender



Two CAT5 Ethernet Cable



CD-ROM with Manual and Quick Setup Wizard

If any of the above items are missing, please contact your reseller.

**Note:** There is only one DHP-W306AV included in this packaging. In order to build your network, you must have two or more PowerLine AV adapters.

### DHP-W306AV

### About Your Product

The PowerLine AV Wireless N Extender DHP-W306AV allows you to connect both wired and wireless computers, high-definition TVs, networking devices, and gaming consoles using the most pervasive medium in your home - the electrical wiring. Share Internet connections and experience smooth file transfers, streaming multimedia, online gaming and more. The PowerLine AV Wireless N Extender features easy plug-and-play installation and can be connected to any Ethernet-enabled and wireless device.

**Note:** For hardware overview, please check the user manual.

### Recommendations

- For best results, use in a regular wall outlet without any other products plugged into the same outlet.
- Connecting this product to a power strip with a surge protector may adversely affect the performance of this product.
- To verify connectivity or if you are having connection problems, plug the adapters in the same room to verify whether your home's electrical wiring is contributing to the issue. The adapters' PowerLine LED indicators will illuminate if the connection is established.

### Hardware Installation - For Wireless Router

**Note:** A minimum of two PowerLine AV devices are required to create a network in order for your product to work properly.

#### Step 1

Plug the PowerLine AV Wireless N Extender (DHP-W306AV) into an AC wall outlet (Please do not plug into a power strip or surge protector) in the same room as your current existing Powerline network in order to verify whether your home's electrical wiring is suitable for the PowerLine network. Turn on the PowerLine AV Wireless N Extender (DHP-W306AV) by pushing the power button located on the side of PowerLine AV Wireless N Extender (DHP-W306AV).

**Note:** Power source is confirmed when the green LED Power Indicator on the PowerLine AV Wireless N Extender (DHP-W306AV) is illuminated. Network Connectivity is confirmed when the green LED PowerLine indicator on both the DHP-W306AV and the Powerline device are illuminated.

#### Step 2

Connect the included Ethernet cable to the network cable connector located on the side of the PowerLine AV Wireless N Extender (DHP-W306AV) and attach the other end of the Ethernet cable to the PC.

**Note:** Connection to an Ethernet-enabled device is confirmed when the Ethernet LED indicator on DHP-W306AV is illuminated

#### Step 3

If you applied security on your other Powerline devices and you have plugged in your new D-Link PowerLine AV Wireless N Extender (DHP-W306AV), press the **Simple Connect Button** on the PowerLine AV Wireless N Extender (DHP-W306AV) for 2 seconds. Then, press the **Simple Connect Button** on any Powerline devices in your existing network for 2 seconds. This must be done within two minutes after pressing the Simple Connect Button on the PowerLine AV Wireless N Extender (DHP-W306AV).

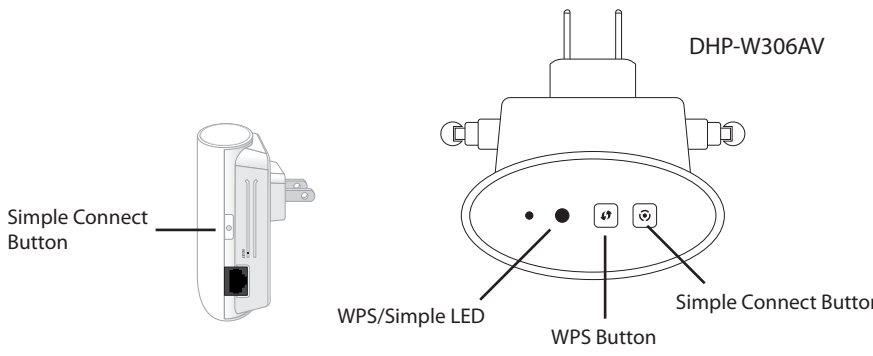

**Note:** The PowerLine LED on both DHP-W306AV and PowerLine devices should blink. Network Connectivity is confirmed when the PowerLine LED indicator on both the DHP-W306AV and the Powerline device are illuminated.

#### Step 4 (One Touch AP Configuration: Apply the same wireless settings to the DHP-W306AV as your existing Wireless Router or Access Point)

Press the **WPS button** on your existing Router or Access Point. The WPS LED will flash on and off. Then, press **WPS Push Button** on the DHP-W306AV and hold it for 5 seconds.

**Note:** Both WPS buttons must be pressed within two minutes. When One click AP setup is complete, your DHP-W306AV will have the same wireless settings as your existing Router or Access Point.

#### Step 5 (Follow if you would like to use the Wireless Settings for your PowerLine that are different from your Wireless Router or Access Point)

To Configure the PowerLine AV Wireless N Extender (DHP-W306AV), open a web browser, enter **http://192.168.0.50** or **http://dlinkap** in the address field and then press **Enter**. When the login window appears, set the user name to **Admin** and leave the password box blank. Click **Log In** to continue the setup. Follow the wizard's instruction to assist you in securing your DHP-W306AV wireless network. Please refer to the **"Wireless Setup Wizard"** in user manual for detailed installation information.

#### Step 6

Once network connectivity is confirmed, you can place the DHP-W306AV PowerLine AV Wireless N Extender in a different room of your home. The DHP-W306AV will retain the security settings even if they are unplugged.

### Your Network Setup - PowerLine Adapter

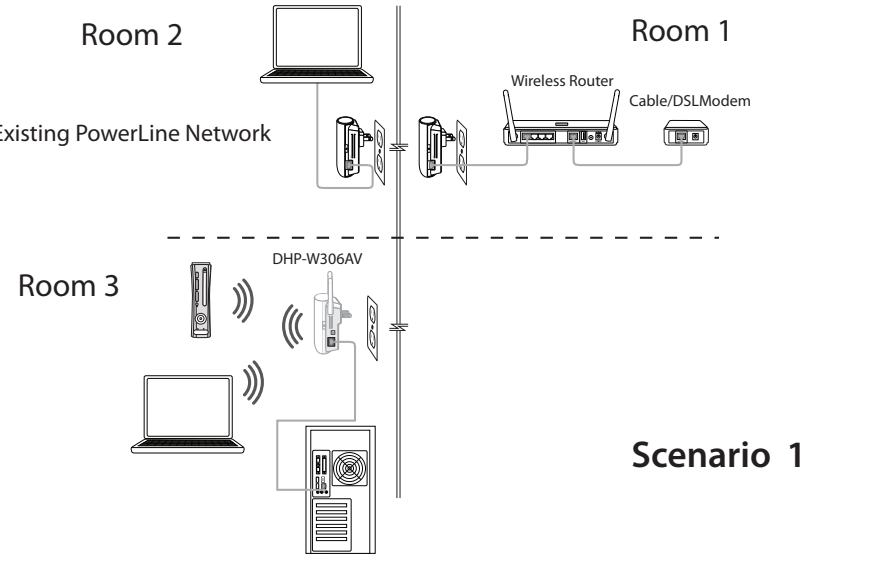

### Scenario 1

### Your Network Setup - PowerLine Router

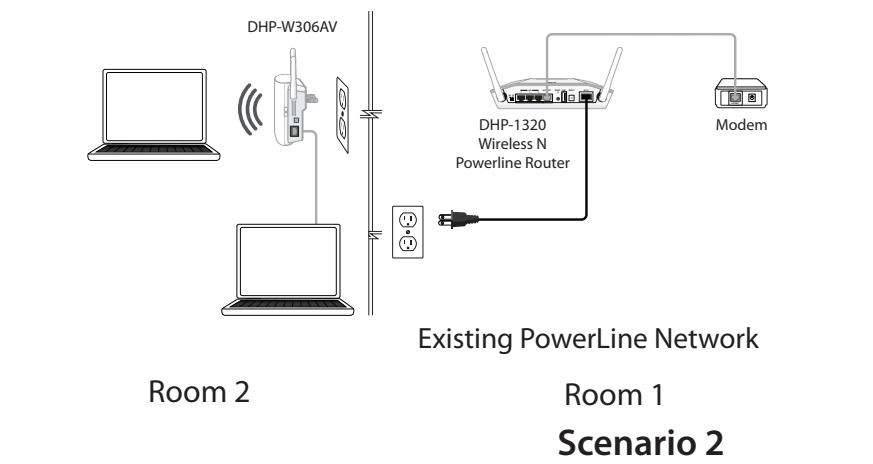

### Scenario 2

### Technical Support

Having trouble installing your new product? D-Link's website contains the latest user documentation and software updates for D-Link products. U.S. and Canadian customers can contact D-Link Technical Support through our website or by phone.

#### United States

Telephone: (877) 453-5465

Internet: <http://support.dlink.com>

#### Canada

Telephone: (800) 361-5265

Internet: <http://support.dlink.ca>

Copyright ©2010 D-Link Corporation/D-Link Systems, Inc. All rights reserved. D-Link and the D-Link logo are registered trademarks of D-Link Corporation or its subsidiaries in the United States and other countries. Other trademarks are the property of their respective owners. Maximum wireless signal rate derived from IEEE Standard 802.11g and 802.11n specifications. Actual data throughput will vary. Network conditions and environmental factors, including volume of network traffic, building materials and construction, and network overhead, lower actual data throughput rate. Environmental factors will adversely affect wireless signal range. Product specifications, size and shape are subject to change without notice, and actual product appearance may differ from that depicted on the packaging. Visit [www.dlink.com](http://www.dlink.com) for more details.

Version 1.1 | June 8, 2011



# Guide D'installation Rapide

DSL-520 Ethernet Modem

Copyright ©2010 D-Link Corporation/D-Link Systems, Inc. All rights reserved. D-Link and the D-Link logo are registered trademarks of D-Link Corporation or its subsidiaries in the United States and other countries. Other trademarks are the property of their respective owners. Maximum wireless signal rate derived from IEEE Standard 802.11g and 802.11n specifications. Actual data throughput will vary. Network conditions and environmental factors, including volume of network traffic, building materials and construction, and network overhead, lower actual data throughput rate. Environmental factors will adversely affect wireless signal range. Product specifications, size and shape are subject to change without notice, and actual product appearance may differ from that depicted on the packaging. Visit [www.dlink.com](http://www.dlink.com) for more details.