



Canon Powershot ELPH 100 HS Battery Replacement

Replace your dying battery to bring the camera back to life.

Written By: Lillia



INTRODUCTION

If your battery light has turned on for you camera, it is dying, and will need a new one, use this guide to help with replacing the battery. This is a very simple procedure, so you have nothing to worry about.

Step 1 — Battery



- Locate the battery cover on the bottom of your camera.
- Slide the tab to the right to open the battery cover.

Step 2

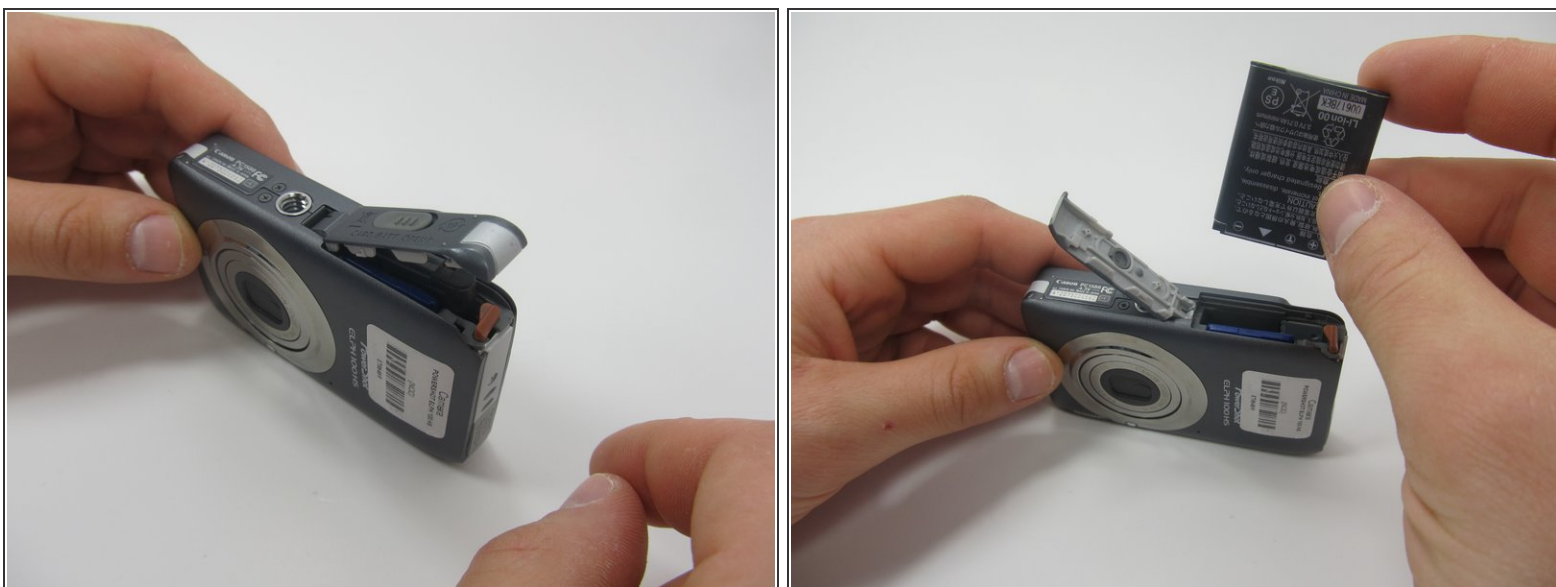

- Flip the battery cover open.
 - Using your fingers, slide the battery out of the camera.
- i** This was not the original battery that came the camera, so yours may look different.

To reassemble your device, follow these instructions in reverse order.

This document was generated on 2019-09-25 09:12:17 AM (MST).

