

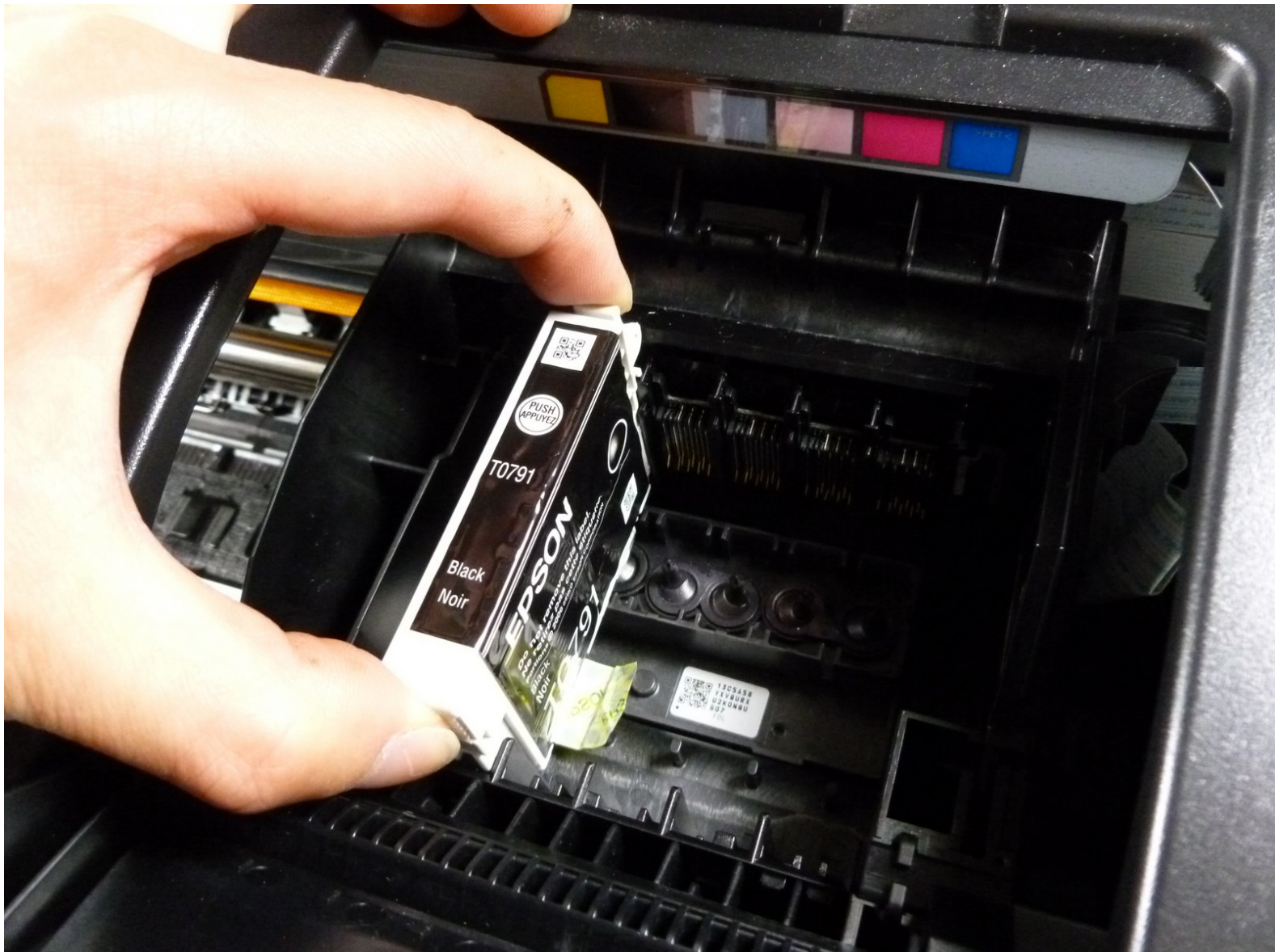

Epson Stylus Photo 1400 Ink cartridge replacement

How to replace Ink Cartridges for the Epson Stylus Photo 1400.

Written By: Larry Huang



INTRODUCTION

This guide shows how to replace an Ink Cartridge. This process requires no necessary tools or knowledge of the device.



PARTS:

- [New Ink Cartridge\(s\)](#) (1)
-

Step 1 — ink cartridge

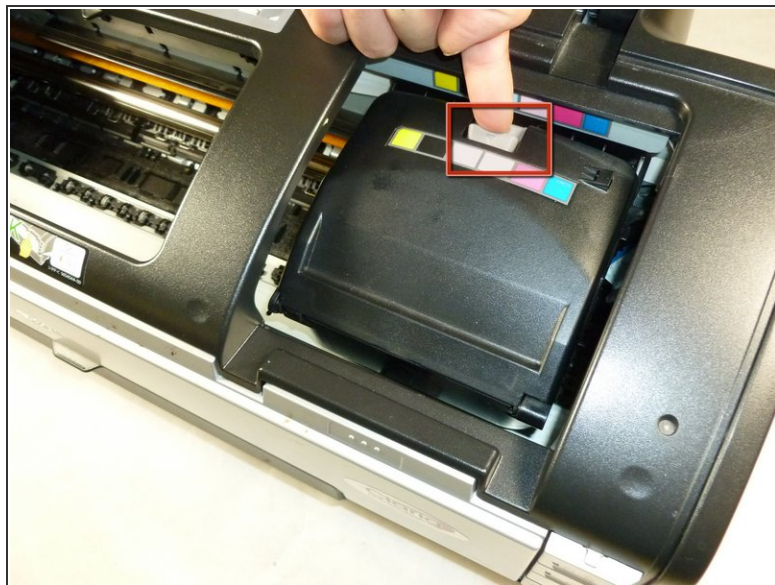

- Open cover of the printer.
- Open the cartridge cover by pressing down on the tab and lifting it up.

Step 2



- Grab the sides of the ink cartridge and pull it out.
- Replace ink cartridge with brand new ink cartridge.

Step 3



- Close cartridge cover.
- Close cover of the printer.

To reassemble your device, follow these instructions in reverse order.