



Fluval 306 Canister Filter Impeller Replacement

Replace the impeller of a Fluval 306 Canister Filter.

Written By: Wayne Truong



Step 1 — Stop Water Flow



- Lift AquaStop Valve lever all the way up. This will stop the water flow and preserve the vacuum so that there shouldn't be a need to prime the filter again.

Step 2 — Unplug Device



- Unplug the device from the electrical outlet.

Step 3 — Removing AquaStop Valve



- Lift the AquaStop Valve latch all the way up.
- Pull the AquaStop Valve up and out of its place in the filter.

Step 4 — Removing Lid



- Make sure the bottom two latches are down.
- Push the top part open and push down on both sides of lid until lid is opened slightly.
- Gently lift lid off of the rest of the case.

Step 5 — Remove Impeller Cover

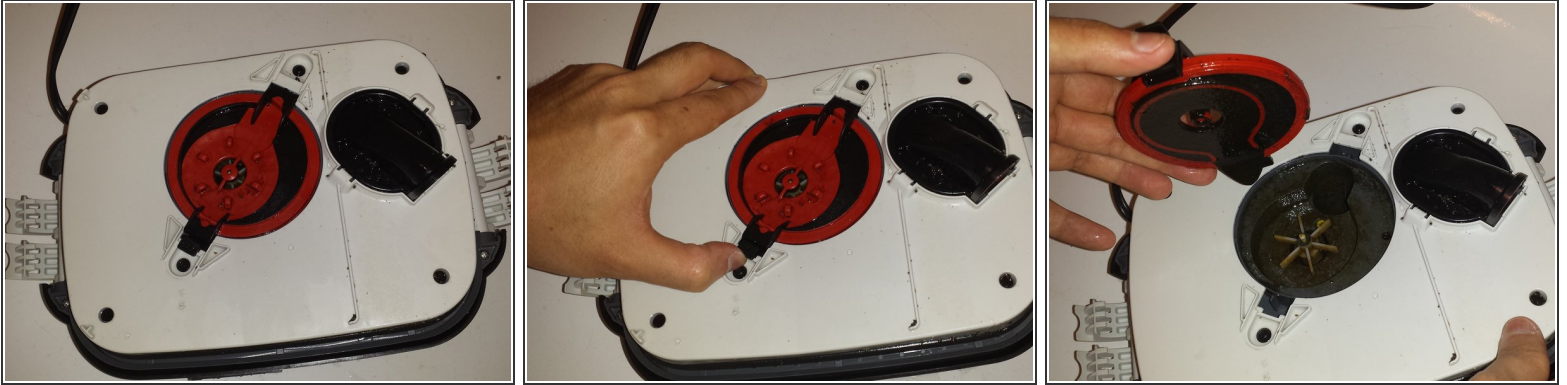

- Place lid so that the impeller cover is facing up.
- Push lock towards impeller while lifting up
- Lift impeller cover up and off the impeller

Step 6 — Removing Impeller

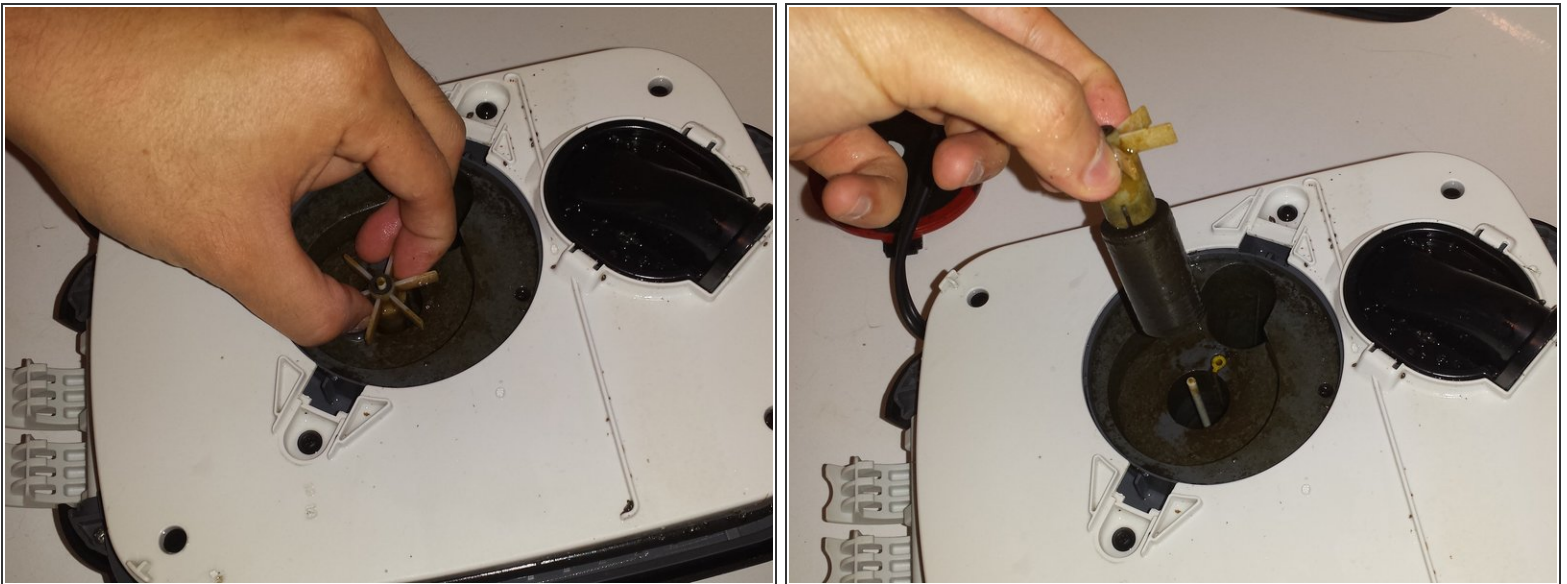

- Firmly lift the impeller up and out of its casing.

Step 7 — Replacing Impeller



- Replace the impeller by holding the shaft and pulling gently on the old impeller until it is released.
- Place the new impeller onto the shaft.

To reassemble your device, follow these instructions in reverse order.