



Fossil Speedway Watch TI-5061 Band Link Replacement

This guide will teach you how to remove one of the band links of the Fossil Speedway TI-5061 wrist watch to adjust the tightness of the band.

Written By: Zachary Price



INTRODUCTION

This guide uses Push-pins and a blunt object such as a hammer. There is potential to hurt yourself with the pin or the blunt object. In this case, the blunt object used was the handles of scissors so also be aware of the potential to cut yourself from the scissors.



TOOLS:

- [Push Pin](#) (1)
 - [Utility Scissors](#) (1)
-

Step 1 — Band Link



- Locate the link on the band with arrows pointing in opposite directions.
- Place push pin into the hole on one side of the link.

Step 2

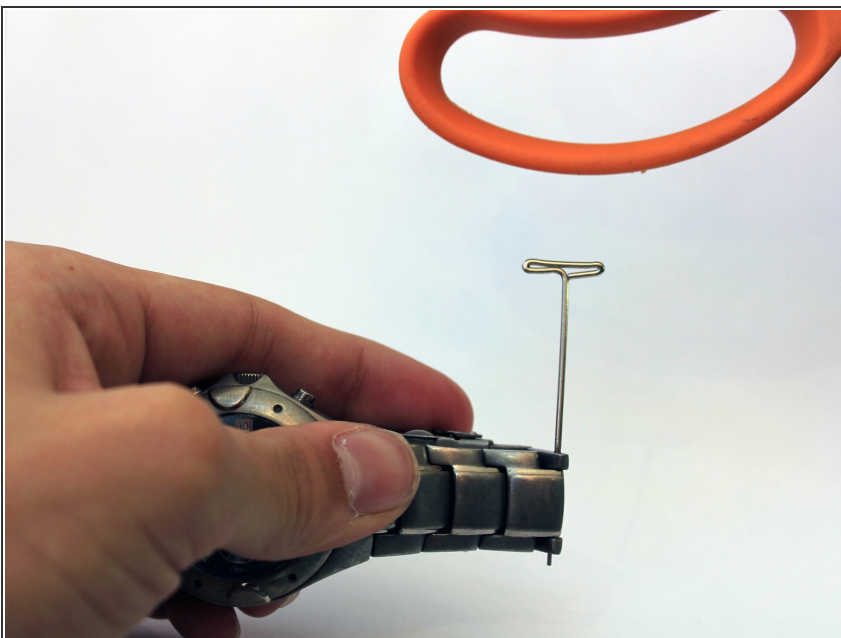

- Hit the push pin with the blunt object (we used scissors) until the small metal rod sticks out from the link.
- Pull the rod out using your fingers.
- Repeat on the other side to remove the entire link.

Step 3



- ☒ To replace the link, insert the open end of one of the connected links into the open end of the new link.
 - Place the rod into the aligning holes and use the blunt object to hammer the rod into the link.

To reassemble your device, follow these instructions in reverse order.