



# Fossil Speedway Watch TI-5061 Clasp Replacement

This guide will teach you how to replace the broken or faulty clasp in the band of Fossil Speedway TI-5061 wrist watch to fix the unlatching watch.

Written By: Sameer Jawale



## INTRODUCTION

This guide will primarily uses Push-pins. There is potential to hurt yourself with the pin. Be careful with the spring-loaded pin holding the clasp as it may bounce out of place.



### TOOLS:

- [Push Pin](#) (1)



### PARTS:

- [Watch Band Clasp](#) (1)

## Step 1 — Clasp

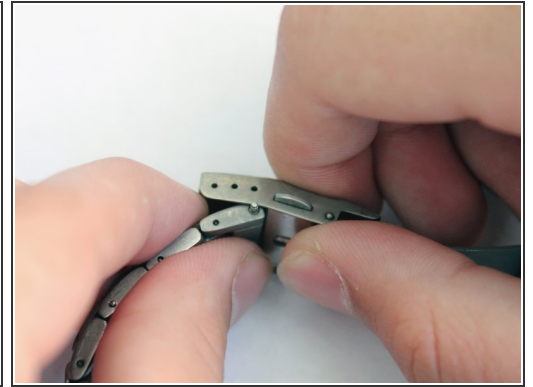
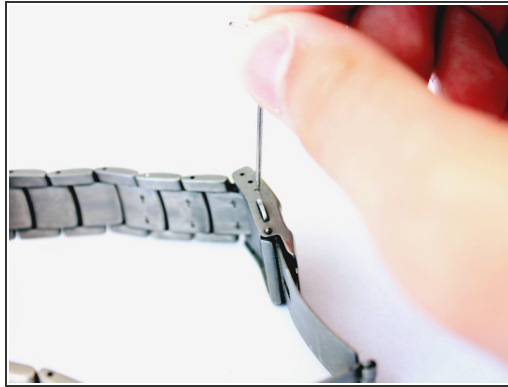

- Keep clasp in open position.
- Push one of the spring-loaded pins out of the hole with a Push-pin.
- Wiggle watch band and clasp till free from each other.

To reassemble your device, follow these instructions in reverse order.