



HP Notebook 15-ay011nr Solid-state drive board Replacement

This guide will show you how to replace the solid-state drive board on an HP Notebook 15-ay011nr.

Written By: Alec Ringberg



TOOLS:

- [Phillips #0 Screwdriver](#) (1)
- [Spudger](#) (1)

Step 1 — Before disassembly



- Before disassembling the computer, follow these steps:
 - Shut down the computer
 - ☑ If you are unsure whether the computer is in hibernation, turn the computer on, and then shut it down through the operating system.
 - Disconnect all external devices connected to the computer
 - Disconnect the power from the computer by first unplugging the power cord from the AC outlet and then unplugging the AC adapter from the computer

Step 2 — Removing the battery

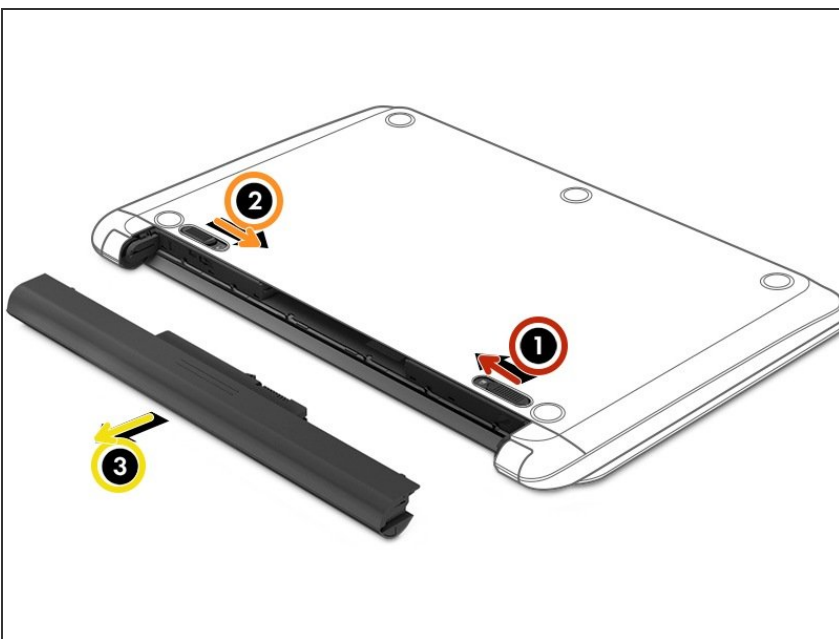

- To remove the battery:
 - Position the computer upside down on a flat surface
 - Slide the battery lock latch (1)
 - Slide the battery release latch (2)
 - Remove the battery (3) from the computer

Step 3 — Optical Drive

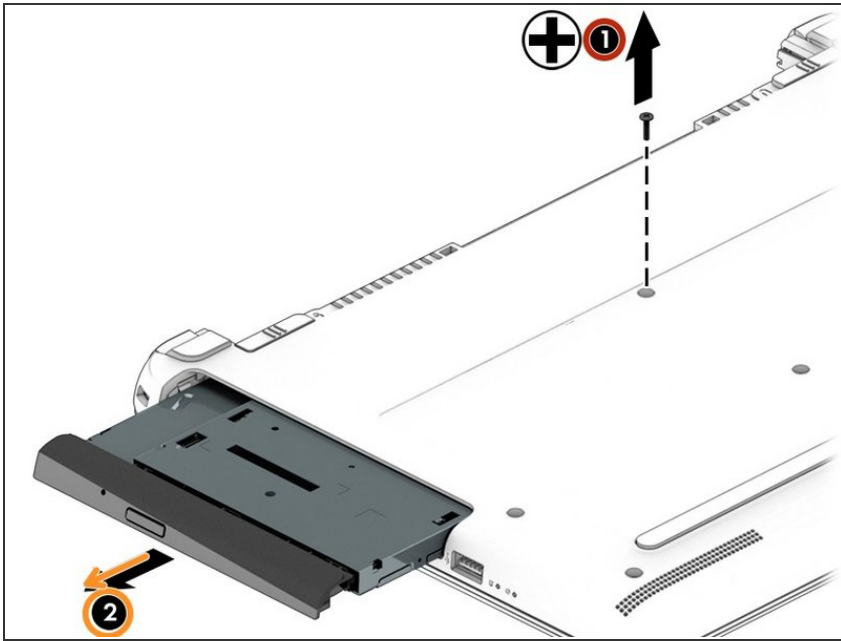

- To remove the optical drive:
 - Remove the Philips PM2.5x6.0 screw (1)
 - Remove the optical drive (2) by sliding it out of the optical drive bay

Step 4 — Bottom Cover

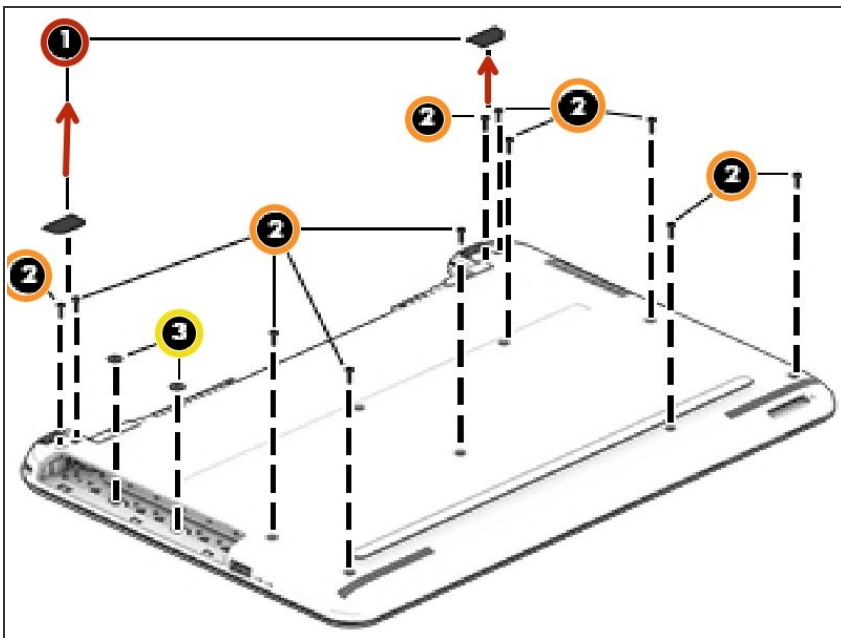

- To remove the bottom cover:
 - Position the computer upside down the the front toward you
 - Remove the two rubber feet from the rear of the bottom of the computer (1)
 - Remove the 11 Philips PM2.5x6 screws (2) from the bottom of the computer
 - Remove the 2 Philips PM2x2 screws (3) from the optical drive bay

Step 5 — Solid-state drive

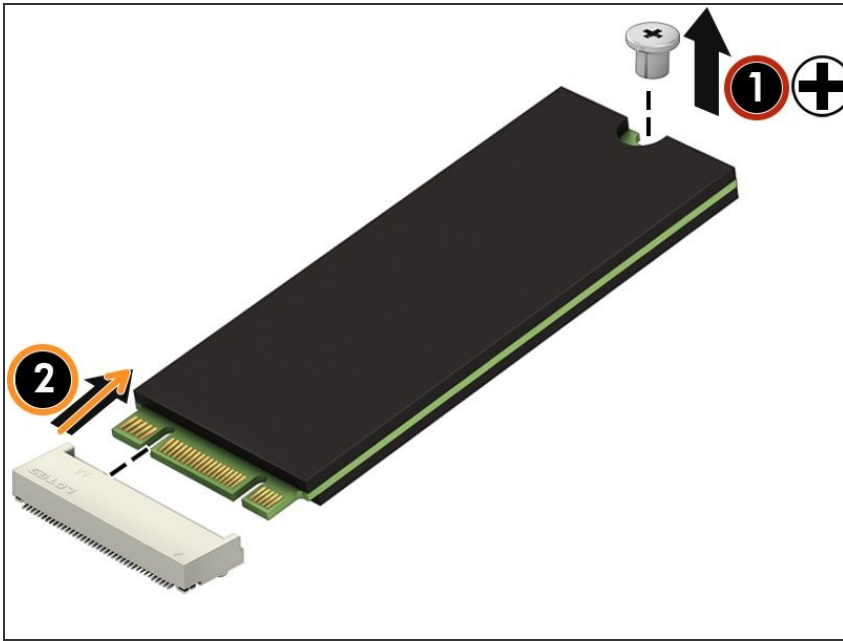

- Remove the solid-state drive
 - Remove the Philips PM2x2 screw (1) that secures the drive to the system board
 - Remove the drive (2) by pulling it away from the connector

Step 6 — Solid-state drive board



- To remove the solid-state drive board:
 - Disconnect the cable from the system board (1)
 - Remove the two Philips PM2.0x3.0 screws (2) that secures the solid state drive board to the computer
 - Lift the board out of the computer (3)

To reassemble your device, follow these instructions in reverse order.