

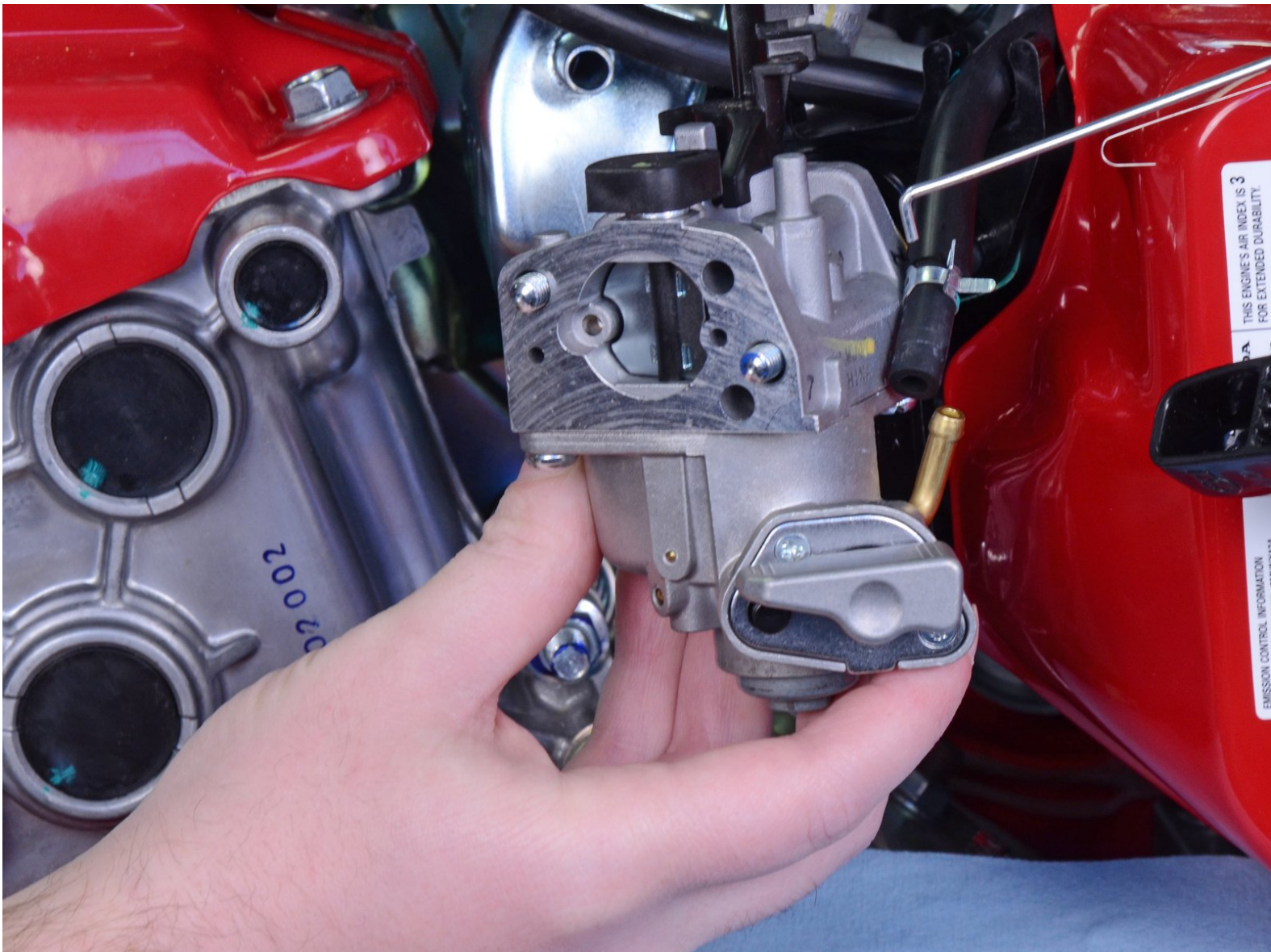

# Honda FC600 Tiller Carburetor Replacement

Replace a worn or damaged carburetor on the Honda FC600 tiller.

Written By: Craig Lloyd



---

## INTRODUCTION

Follow this guide to replace a worn or damaged carburetor on the Honda FC600 tiller.

---



### TOOLS:

- [10mm Socket](#) (1)
  - [Socket Wrench](#) (1)
  - [Snap Ring Pliers](#) (1)
  - [Nitrile Gloves](#) (1)
  - [Large Needle Nose Pliers](#) (1)
-

## Step 1 — Remove the Spark Plug Cap

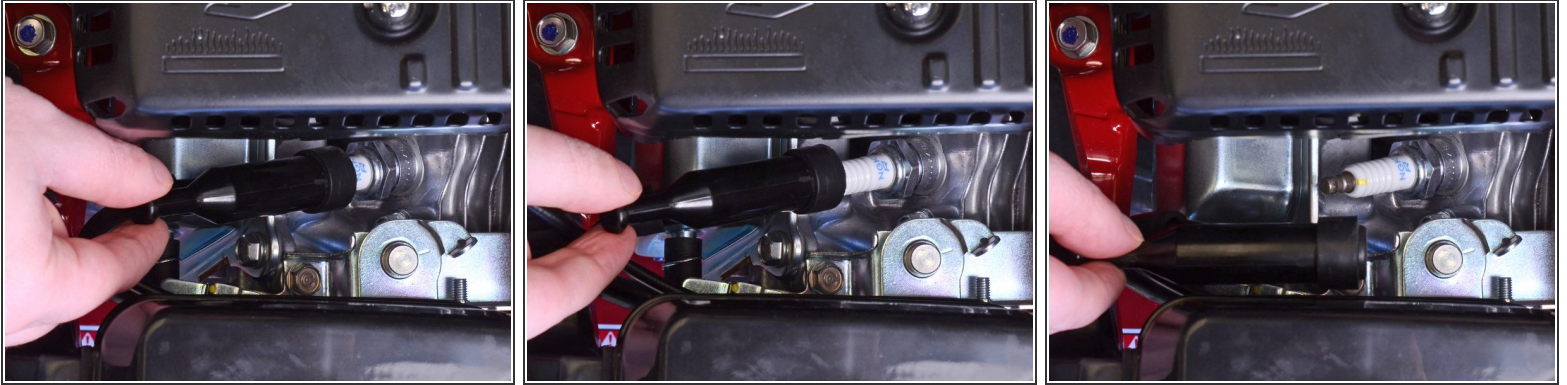

 Before you begin, it's important that you completely cut power to the tiller by disconnecting the spark plug. This will prevent the engine from accidentally starting up while you're working on the tiller.

- Grab the spark plug cap and pull it straight out to disconnect the spark plug from the engine.

## Step 2 — Remove the Air Filter Cover

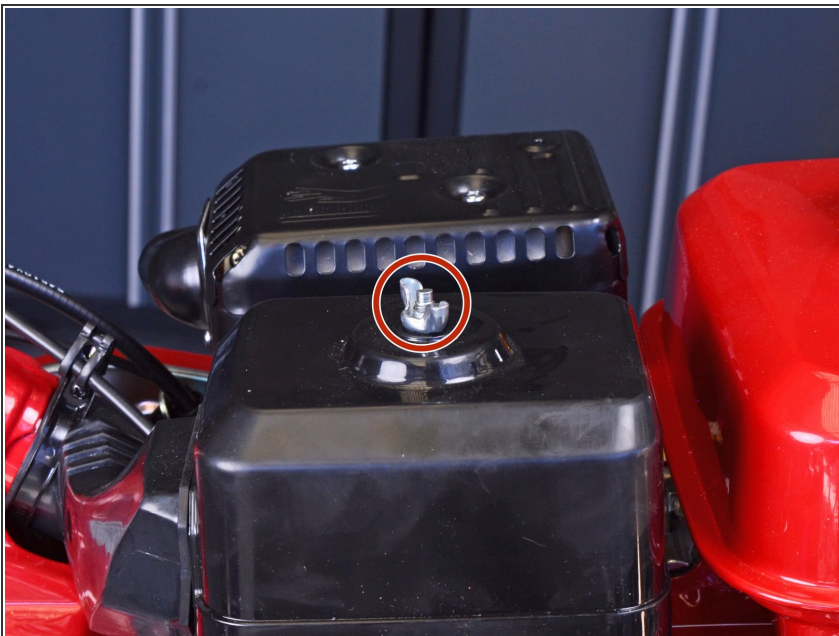

- Use your fingers to unscrew and remove the wing nut securing the air filter cover to the air filter elbow.



## Step 3

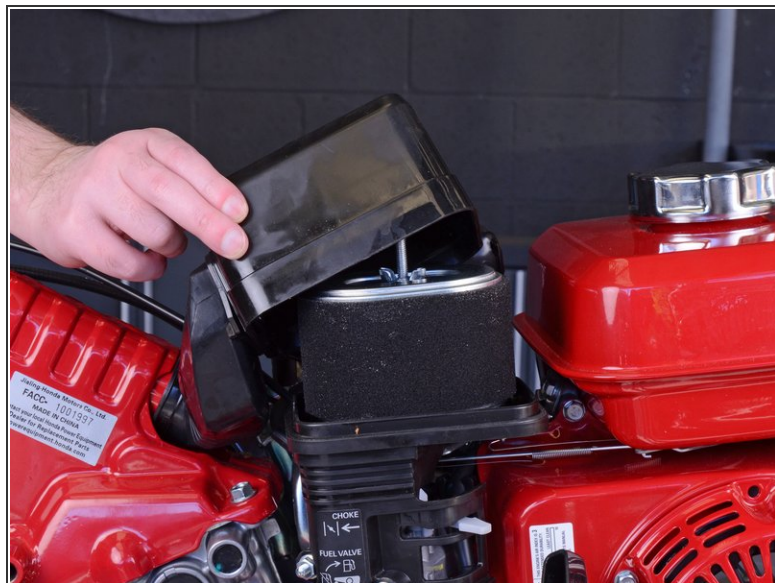
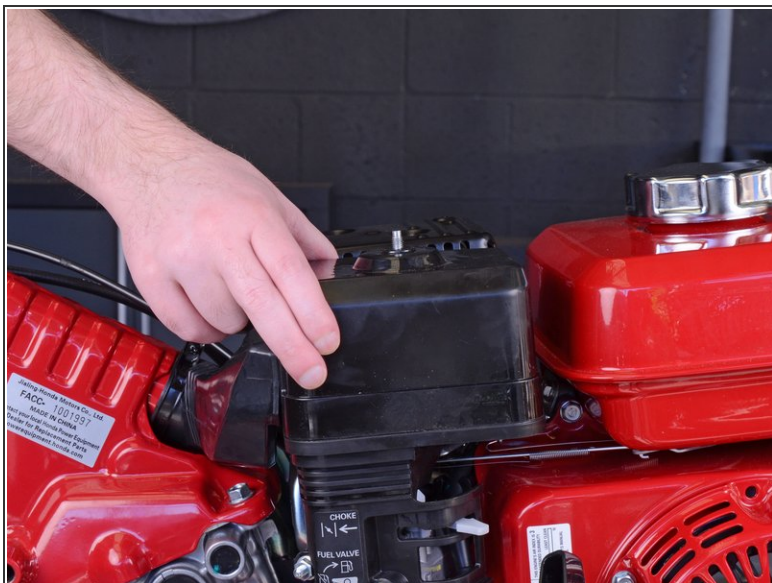

- Lift up and remove the air filter cover to reveal the air filter.
- ❗ The air filter cover will still be attached to the tiller by a flexible hose. You can push the cover to the side while you continue to work on the tiller, or follow the next two steps to completely remove the cover.

## Step 4 — Detach the Air Filter Cover



- i** The next two steps are optional, but they will make it easier to work on the tiller from here on out.
- Squeeze the metal clip on the inside of the air filter cover and remove it.

## Step 5



- Hold onto the air filter hose and pull on the air filter cover to remove it.



## Step 6 — Remove the Air Filter

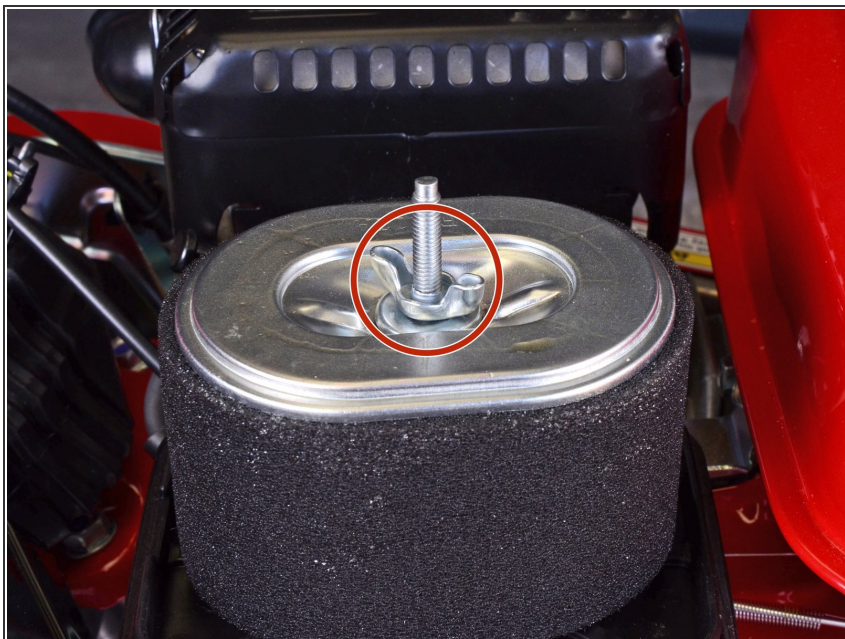

- Use your fingers to unscrew and remove the wing nut securing the air filter to the air filter elbow.

## Step 7



**i** Wear gloves or use a rag during this step, as the air filter is coated with oil.

- Lift the air filter straight up off the elbow, making sure it clears the threaded rod.

## Step 8 — Remove the Air Filter Elbow

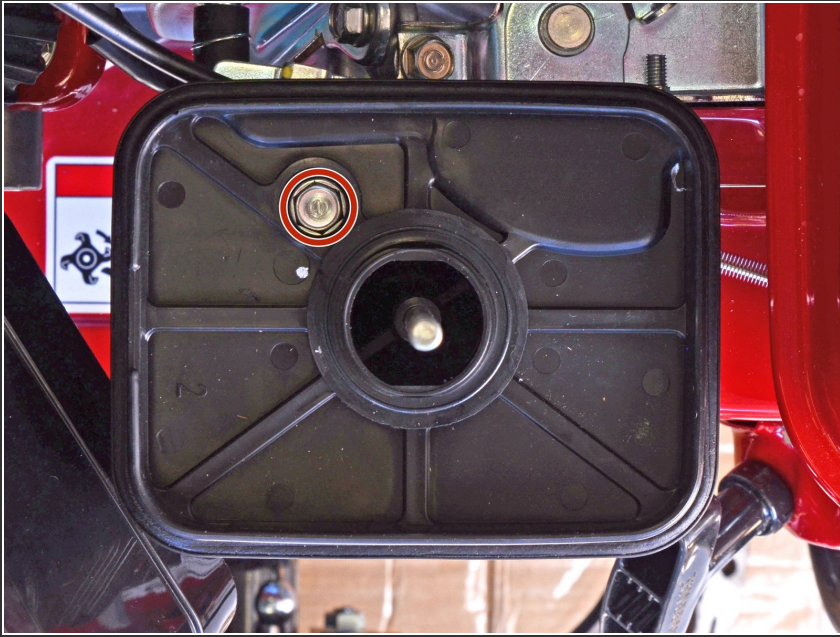

- Use a 10mm socket and socket wrench to remove the 25.5 mm-long bolt securing the air filter elbow to the tiller.

## Step 9

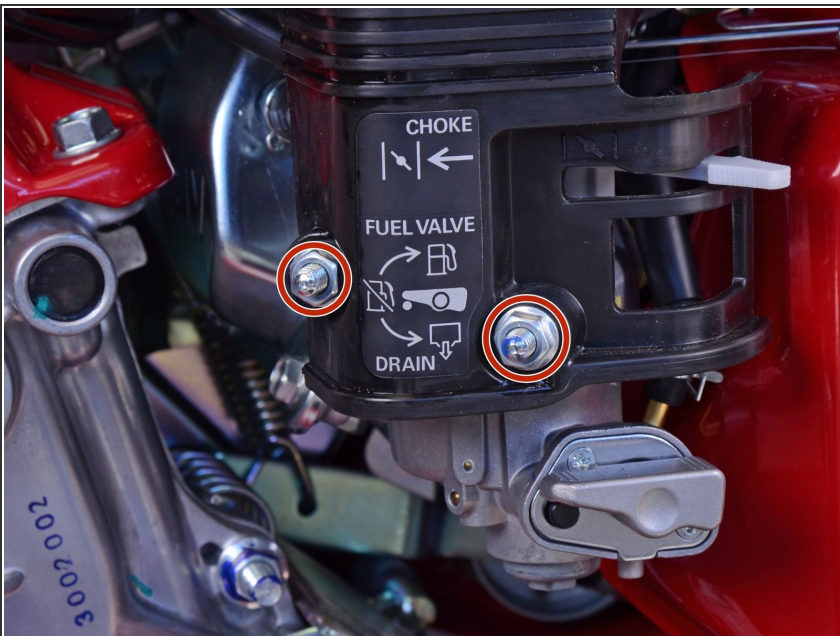

- Use a 10mm socket and socket wrench to remove the two nuts securing the air filter elbow to the carburetor's threaded rods.



## Step 10

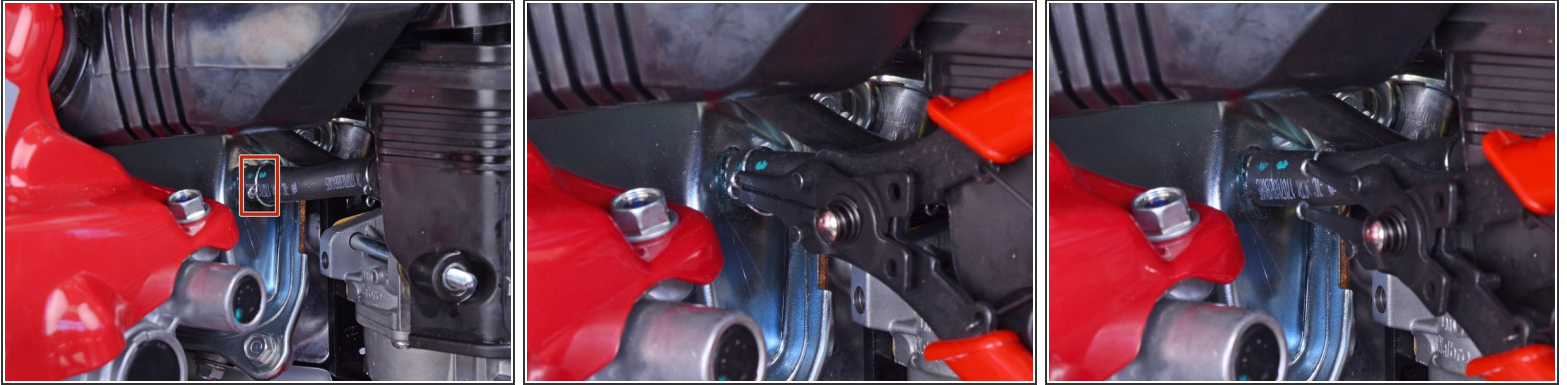

- Use a pair of snap ring pliers to loosen the spring hose clamp on the breather tube, pulling it out 2-3 cm so it's not clamping onto the end of the tube.

## Step 11

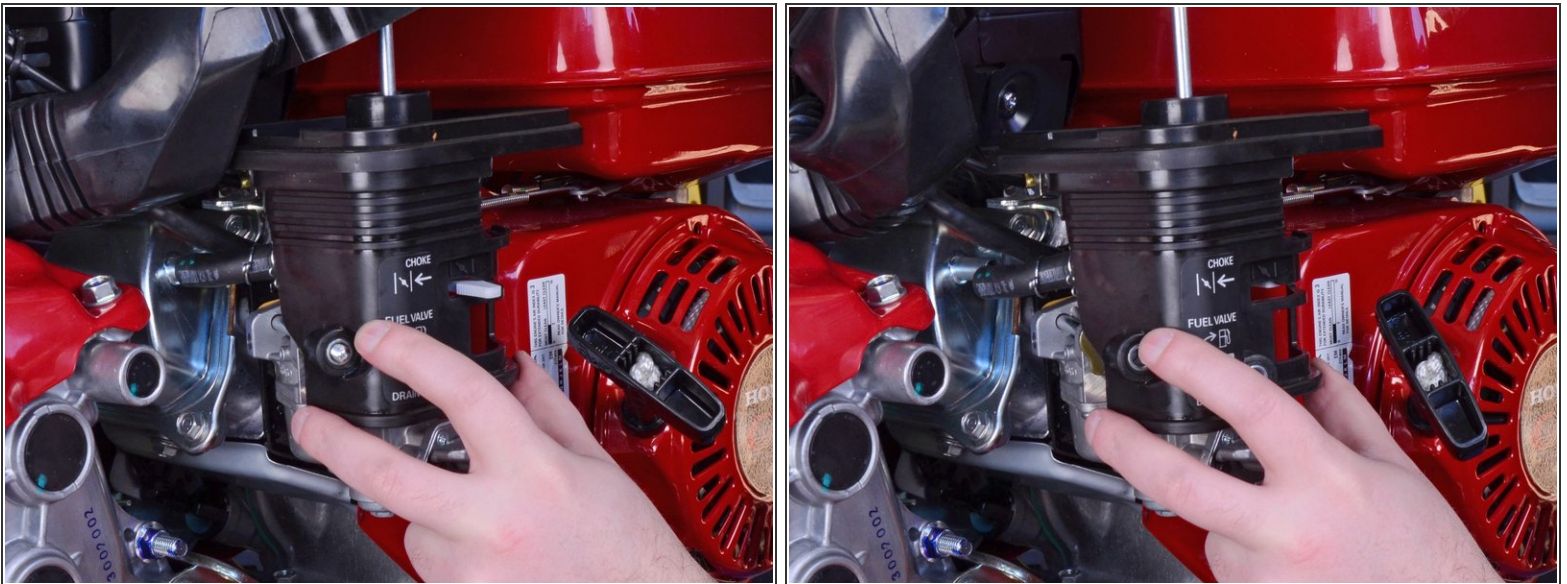

- Pull the air filter elbow straight off, making sure it clears the carburetor's threaded rods.
- ⓘ As you remove the elbow, you may need to use your other hand to remove the breather tube from the engine's valve cover.



## Step 12 — Remove the Carburetor Spacer

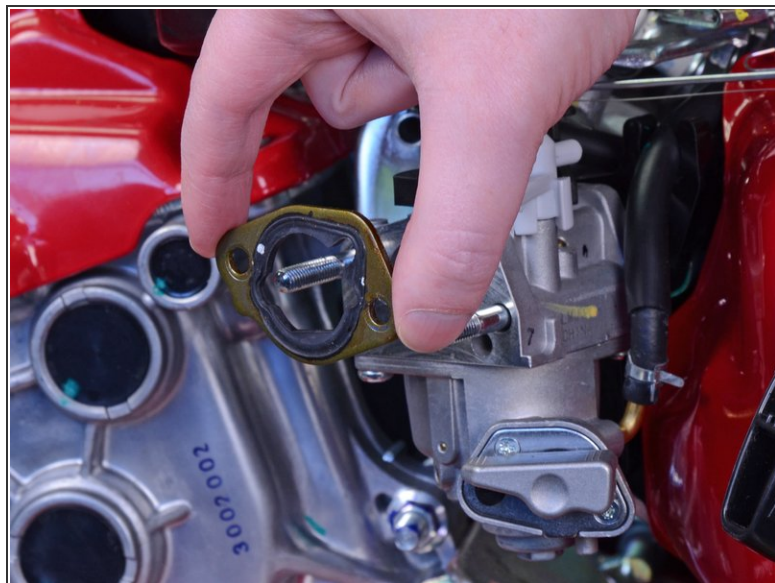
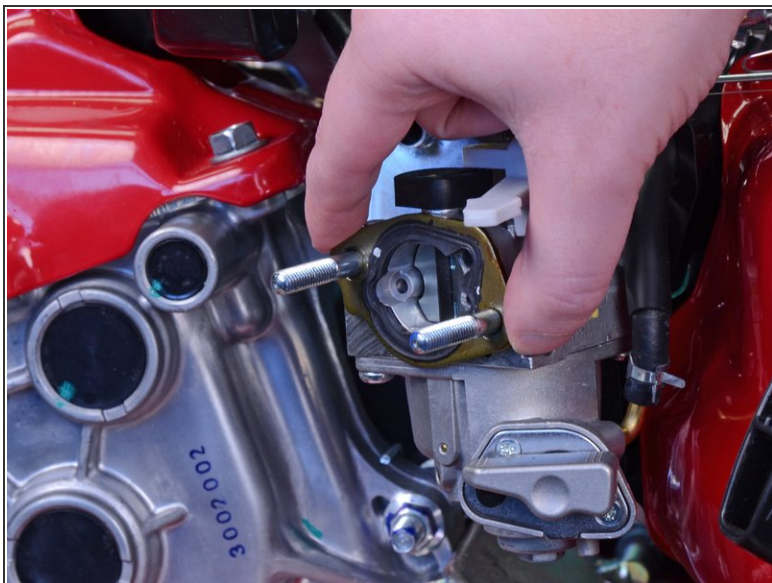

- Pull the carburetor spacer straight off, making sure it clears the threaded rods.

## Step 13 — Remove the Choke Lever

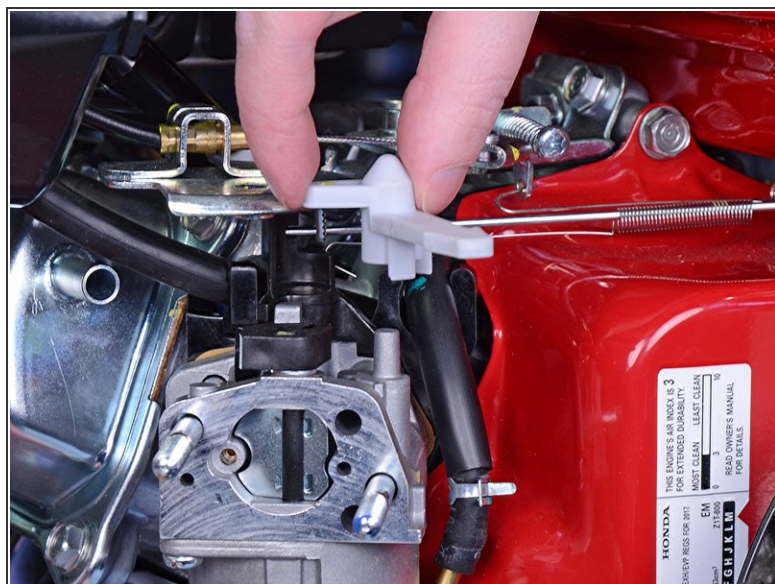
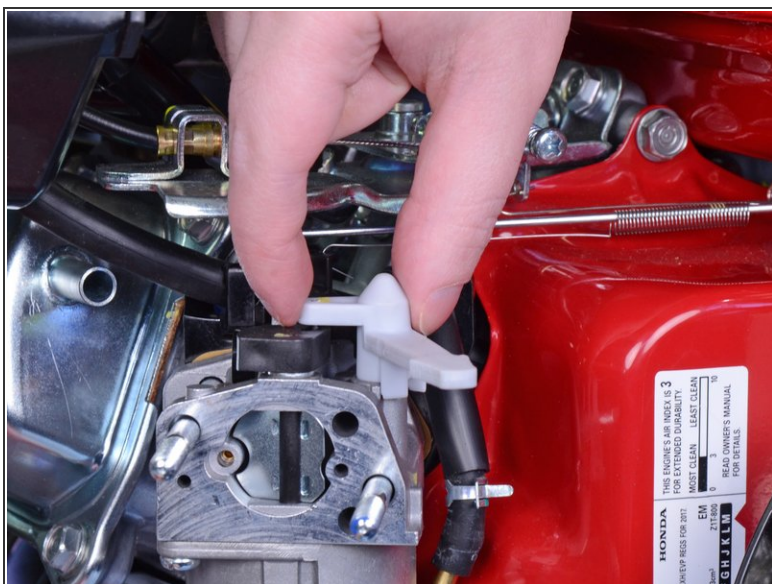

- Pull the choke lever straight up to remove it from the carburetor.



## Step 14 — Drain the Gasoline from the Carburetor



**i** The next two steps demonstrate how to empty gasoline out of the carburetor before removal.

- Press and hold down the fuel valve's safety lock button.
- Begin to turn the fuel valve knob counter-clockwise, continuing to hold down the safety lock button until the knob clears the button.

## Step 15

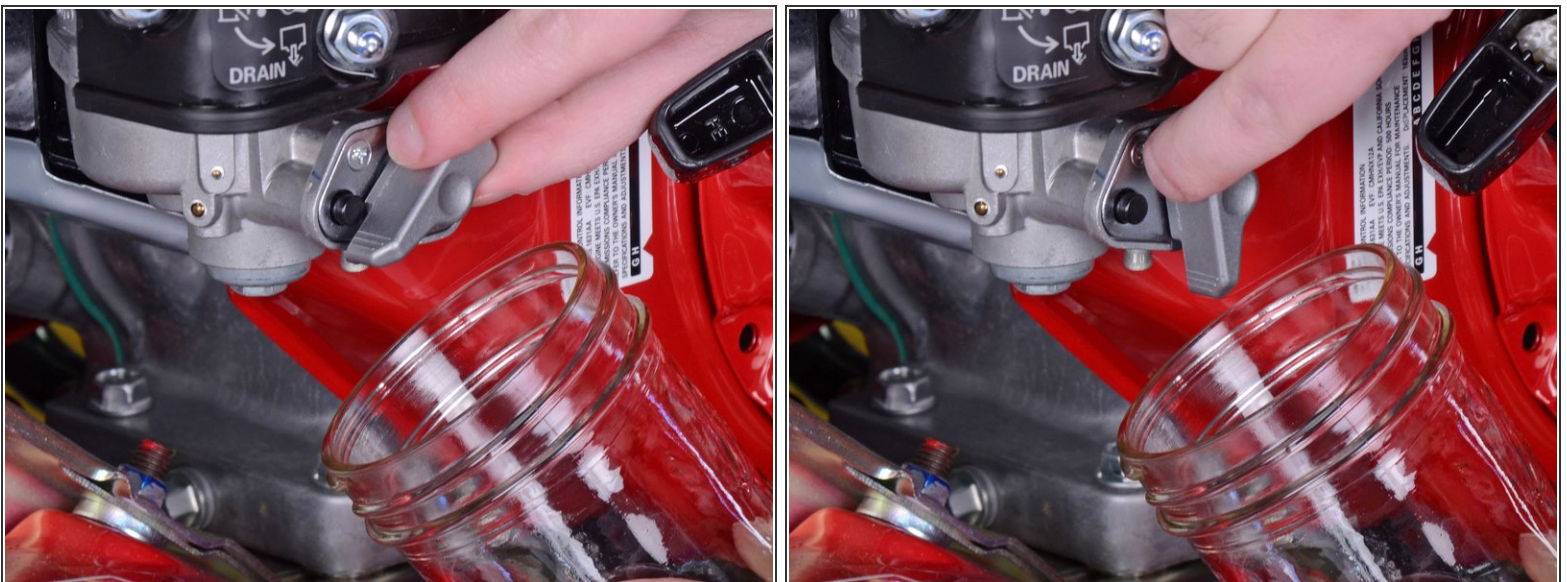

- Place a small gasoline-safe container under the drain spout.
- Turn the fuel valve knob counter-clockwise until it faces downward to drain any gasoline that may be remaining in the carburetor.



## Step 16 — Disconnect the Fuel Supply Hose

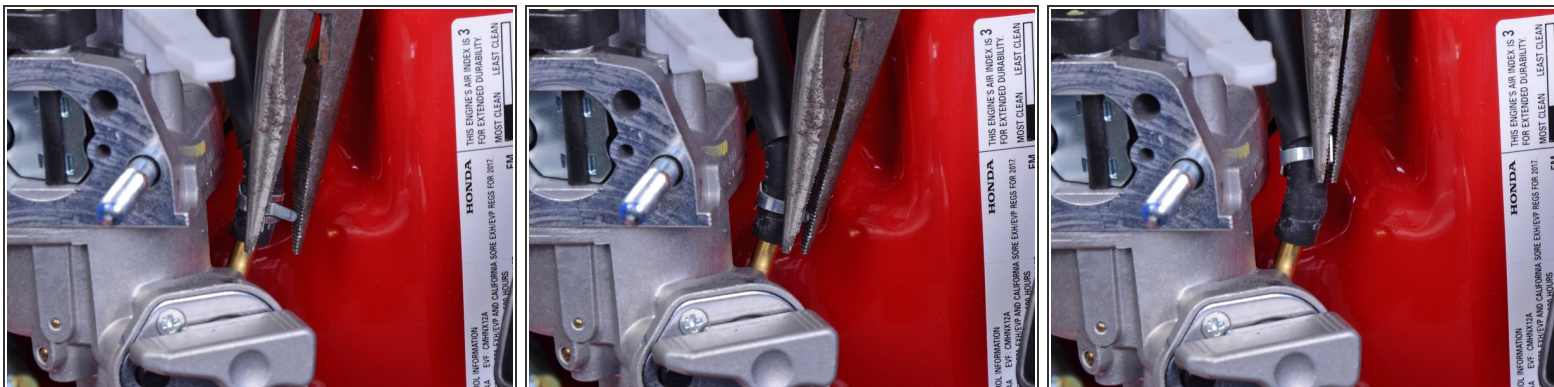

- Use a pair of needle nose pliers to squeeze and loosen the spring hose clamp on the fuel supply hose.
- Move the clamp up 2-3 cm so it's not clamping down onto the end of the tube.

## Step 17

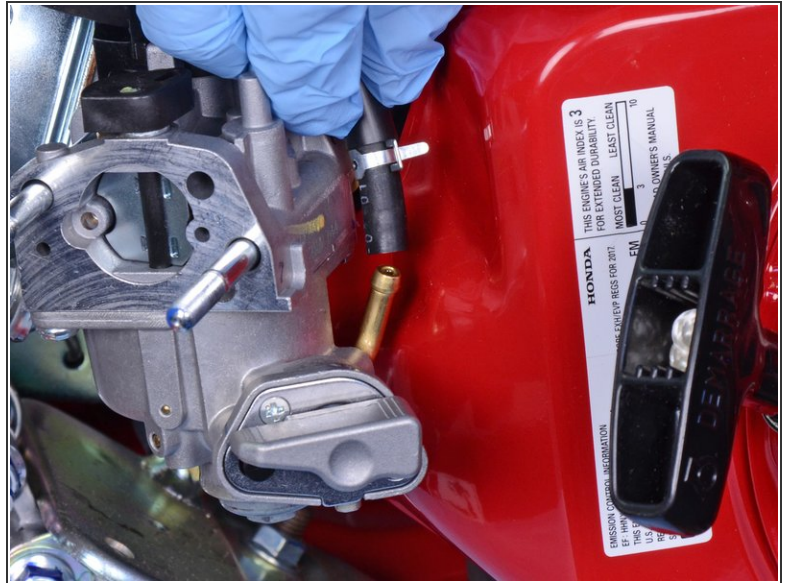
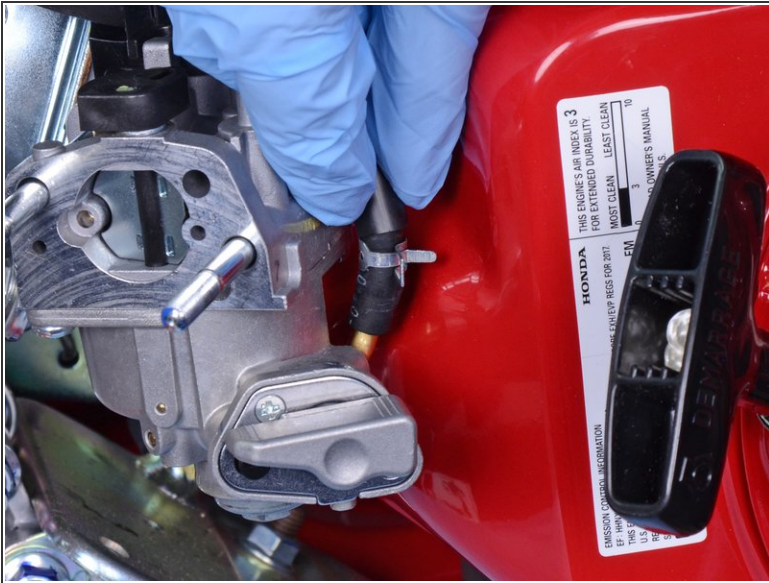

- ⓘ Wear gloves or use a rag during this step, as gasoline will begin to drain out once you remove the hose.
- ⓘ If you didn't completely drain the fuel tank beforehand, have a gasoline-safe container ready to catch the gasoline as it drains out of the hose.
- Grab onto the end of the fuel supply hose and pull it straight up to disconnect it from the carburetor.



## Step 18 — Disconnect the Throttle Spring and Governor Rod

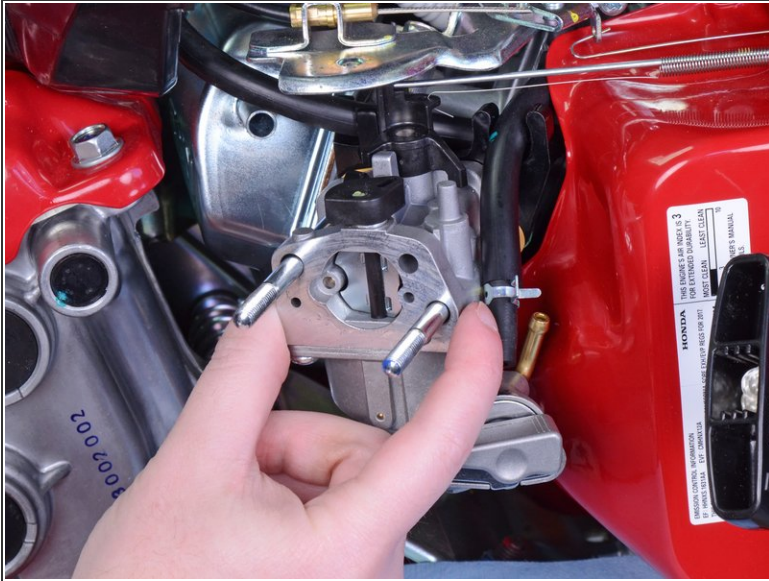

- Pull the carburetor halfway out, but do not completely remove it yet.

## Step 19

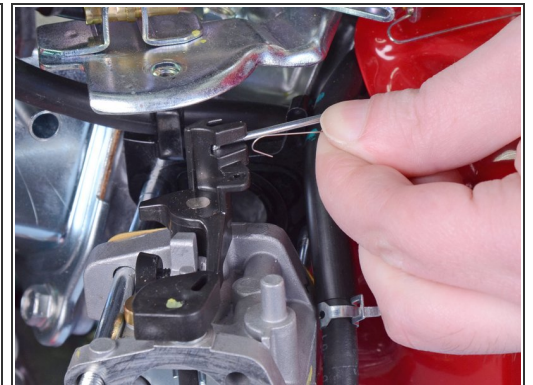
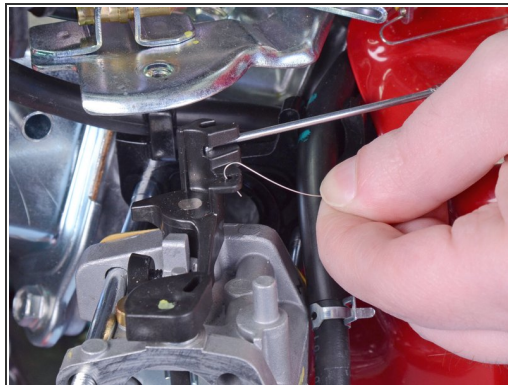
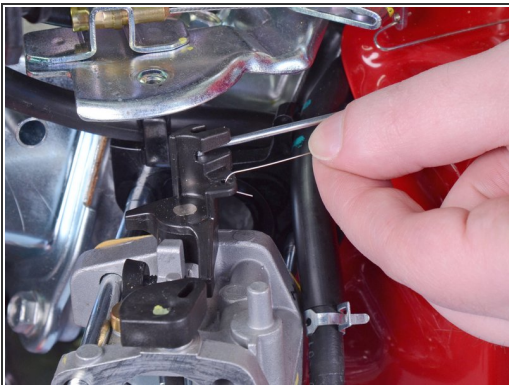

- Grab the throttle return spring and push it down to point the tip of the hook downward.
- Apply an upward motion to lift the tip of the hook out of its connector on the carburetor.



## Step 20

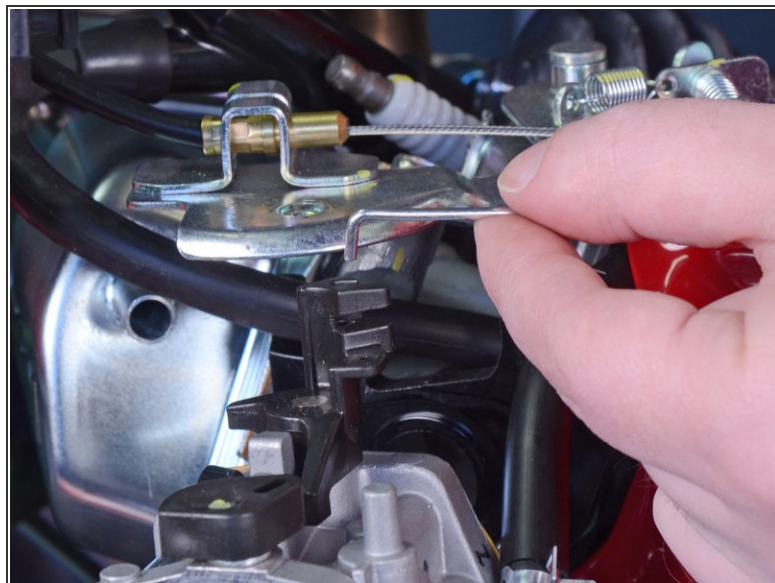

- Grab the governor rod and lift it straight up to remove it from the carburetor.

## Step 21 — Remove the Carburetor

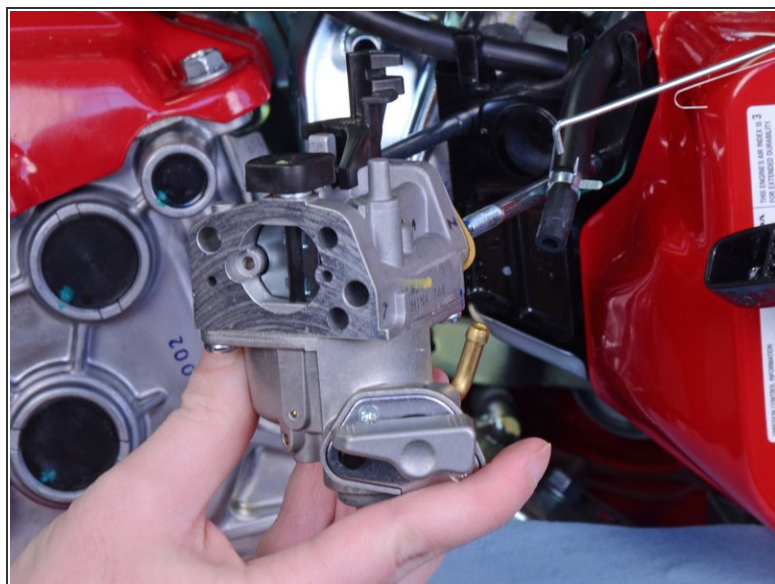
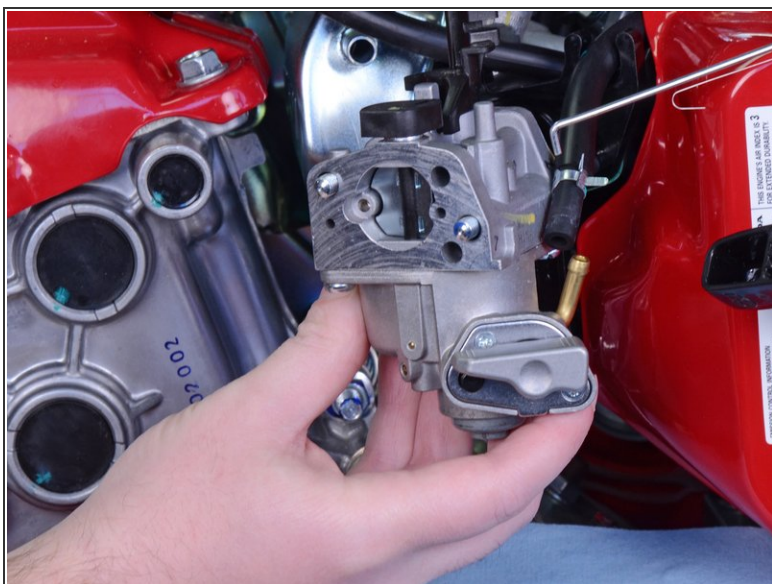

- Pull the carburetor straight off of the threaded rods to remove it.



## Step 22

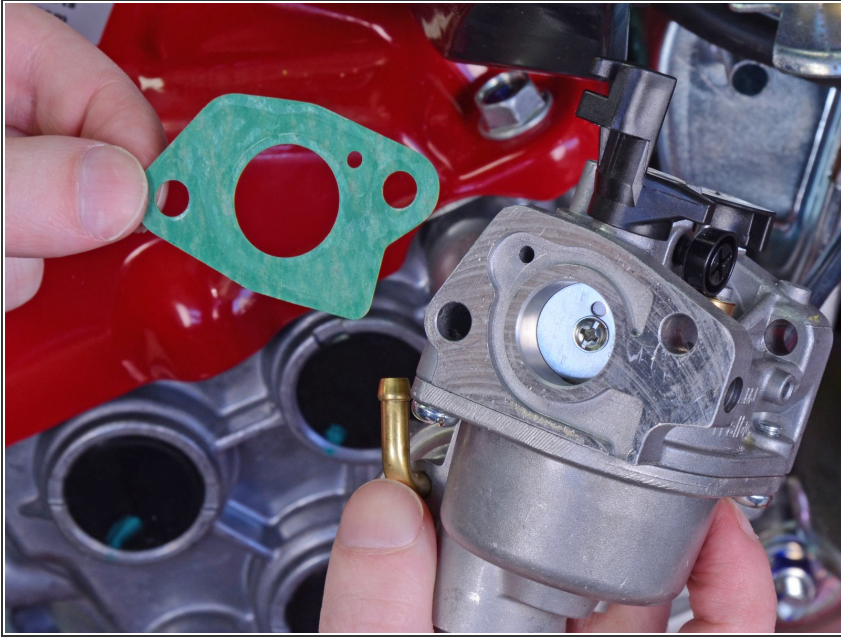

- ⓘ The outlet on the rear of the carburetor has a thin gasket. Inspect the gasket's condition and replace if needed.

To reassemble your device, follow these instructions in reverse order.