



How to Change an Indoor Doorknob Handle

This guide shows you how to take out an indoor doorknob and replace it with a new doorknob.

Written By: Mallory



INTRODUCTION

This guide will show you how to replace your old indoor doorknob and assemble a new doorknob. You will need a Phillips head screwdriver as well as a new indoor doorknob set. Both can be bought from any hardware store.



TOOLS:

- [Phillips #2 Screwdriver](#) (1)



PARTS:

- [Door knob with screw holes \(outside of the room\)](#) (1)
- [Door knob with peg and screw holes \(inside of the room\)](#) (1)
- [Latch mechanism with latch face](#) (1)
- [2 Short Screws](#) (1)
- [2 Long Screws](#) (1)

Step 1 — How to Change an Indoor Doorknob Handle

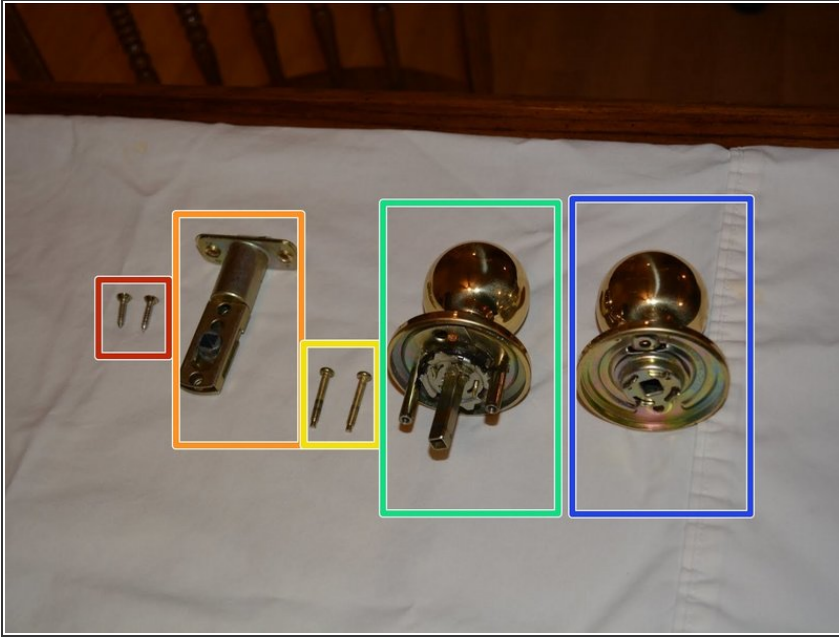

- Parts: (in order from left to right)
 - Short Screws
 - Latch mechanism with latch face
 - Long screws
 - Door knob with peg and screw holes (inside of the room)
 - Door knob with screw holes (outside of the room)

Step 2



- Face the inside of the knob, you should see two Phillips head screws on either side of the central knob.

Step 3



- Unscrew both long screws.

Step 4



- Remove the door knob on both sides of the door.

Step 5

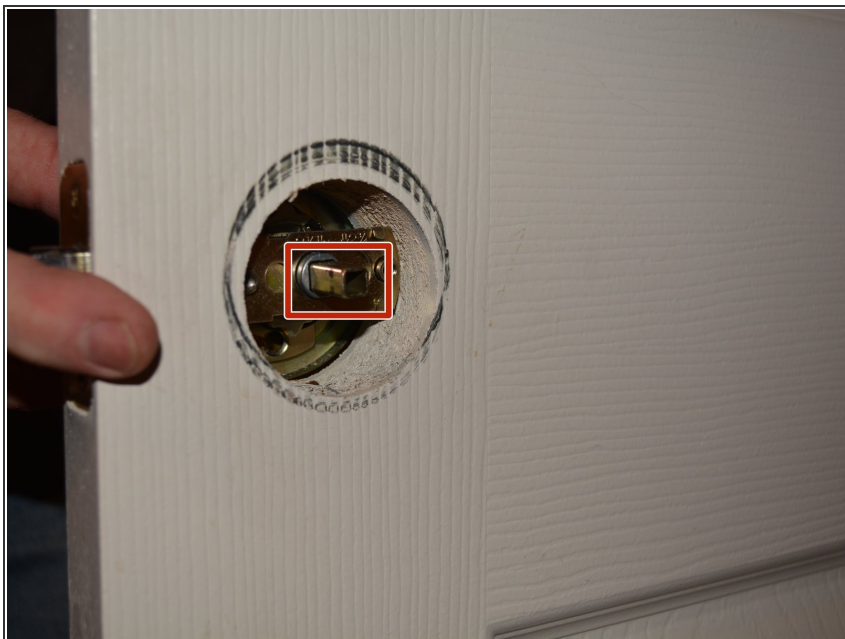

- You will see the latch face plate (the rectangular piece of metal) where the latch of the door knob is located.

Step 6



- Unscrew the two short screws on the latch face plate.

Step 7



- Remove the latch face plate and latch mechanism.

Step 8



- Push the new latch mechanism with latch face plate into the door.
- ⓘ The slanted side of the latch mechanism will be facing the direction that the door closes.

Step 9

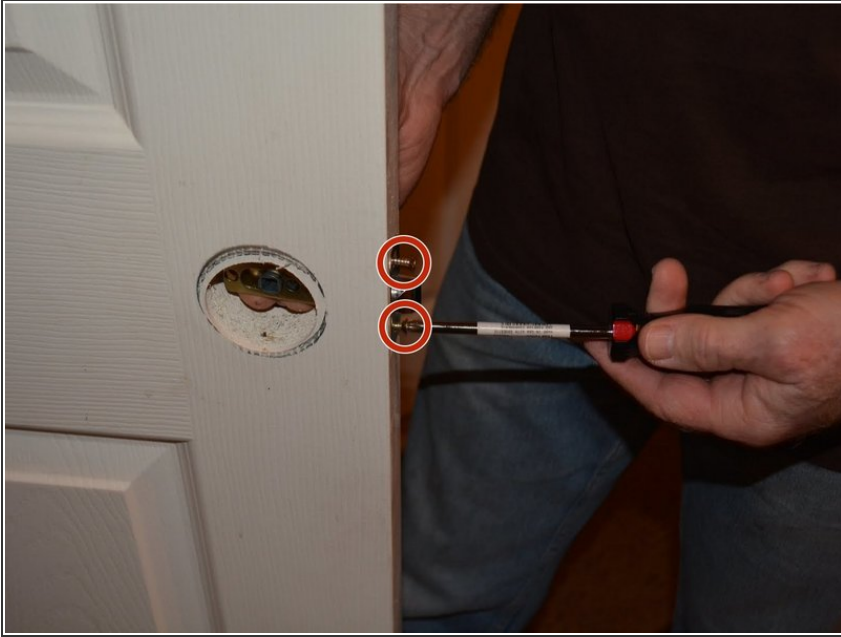

- Screw in both short screws of the latch face plate.

Step 10



- Insert the door knob that goes on the inside of the room, aligning the peg and screw holes with the threaded cylinders of the latch mechanism.

Step 11

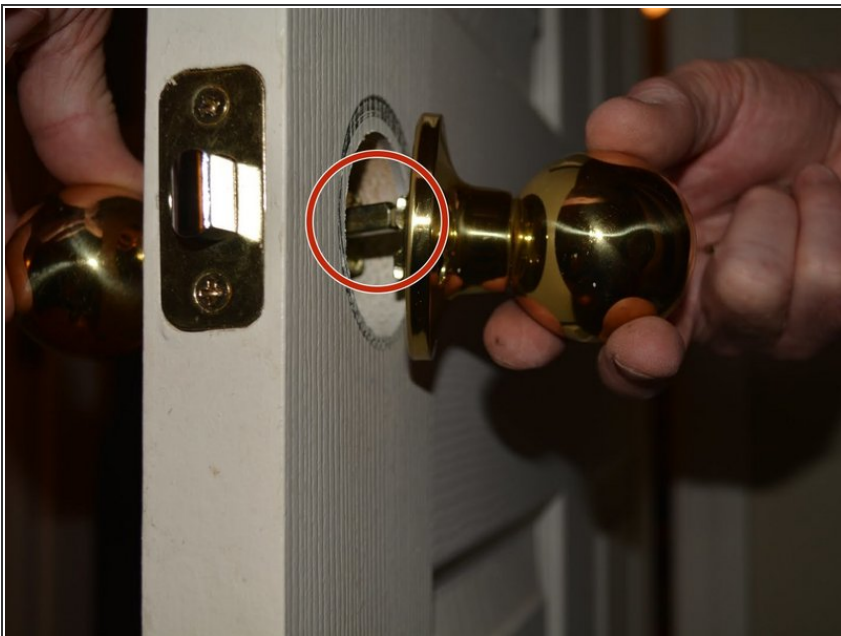

- Align the door knob that goes on the outside of the room, aligning the peg and screw holes with the threaded cylinders of the latch mechanism.

Step 12



- Screw in both long screws on both sides of the door knob.

Step 13

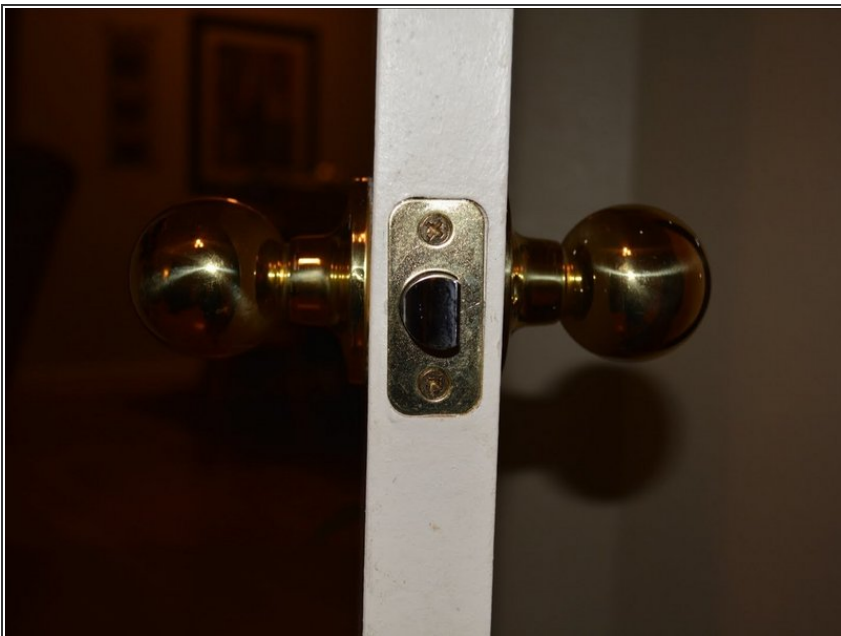

- Turn the door knob to test your work.

To put the old door knob back on or to change to a different door knob repeat steps from the beginning.