



# How to Fix a Rattling Door

This guide will explain how to fix a loose door that rattles in the closed position.

Written By: Sara Novell



---

## INTRODUCTION

Sometimes doors don't fit well into their frames. That's due to the spring loaded lock not fitting well into the strike plate of the door. This can get annoying when wind blows through the house and rattles the door. The problem probably originates from the metal tab on the strike plate being bent away from the door.



### TOOLS:

- [Flathead Screwdriver](#) (1)
  - [Philips screwdriver](#) (1)
  - [Small Needle Nose Pliers](#) (1)
-

## Step 1 — How to Fix a Rattling Door

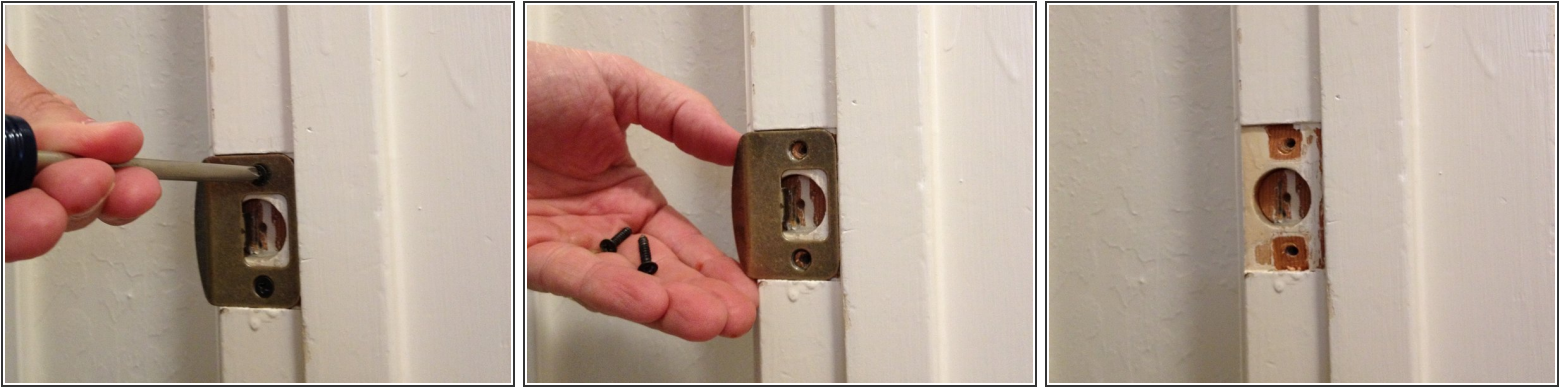

- Remove the strike plate on the door by unscrewing the screws that attach it to the door frame.
  - ❗ The type of screwdriver you need depends on the type of screws that hold your strike plate in your door.

## Step 2



- Take the strike plate and put it in your hand. Using the pliers in your other hand, bend the metal tab toward the flat side of the strike plate.



### Step 3



- Place the strike plate back on the door frame and tighten the screws.

Close your door and shake it back and forth to see if it is still loose. Repeat the guide steps as necessary.