



How to Replace The Bulb In A Spice Lab Himalayan Crystal Salt Lamp

This guide will explain how to replace a broken light bulb in a Spice Lab brand Himalayan Crystal Salt Lamp.

Written By: Matthew Atwill



INTRODUCTION

This fast fix will help guide users through the process of removing a light bulb from a Spice Lab Himalayan Crystal Salt Lamp and replacing it. This specific guide uses an E12 light bulb, but other models from other companies could use different bulbs and be constructed in a different manner. Be sure to check your specific brand and model for additional details that could require additional steps.

Step 1 — Spice Lab Himalayan Crystal Salt Lamp Bulb Replacement



- Rotate the power switch in the counterclockwise direction to halt electricity flow to the lamp.
 - Be sure to unplug the lamp to mitigate risk.
 - Wait 5-10 minutes to allow the bulb to cool before continuing.
- ⚠ Salt lamps, especially this model, are very dense and capable of causing damage to you or your environment if dropped.
- ⚠ Be sure to perform this fix on a sturdy and level surface.

Step 2



- Flip the lamp so that the base is accessible.

Step 3



- Using your hands, pull the black circular light fixture out of the salt lamp.

Step 4

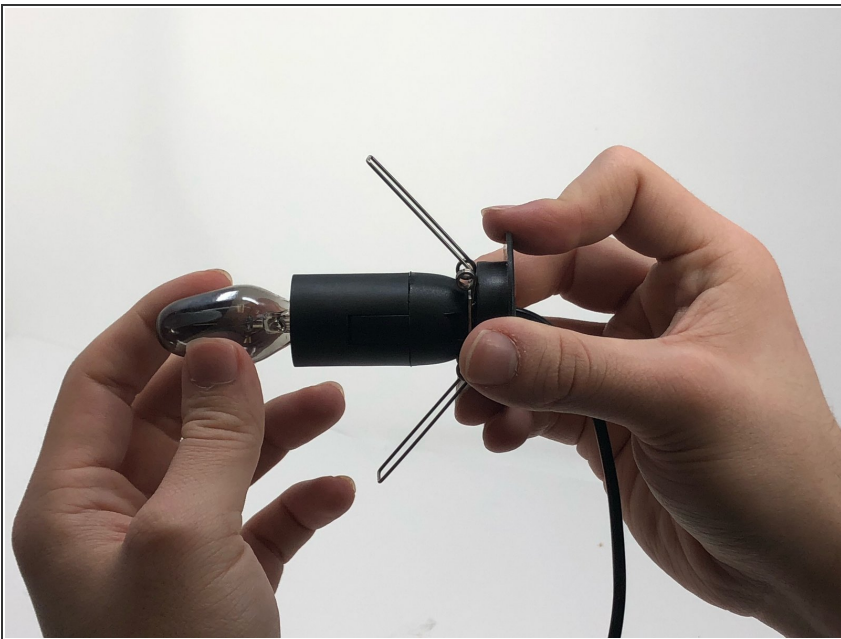

- Using your fingers, twist the light bulb in the counterclockwise direction to remove the bulb.

Step 5

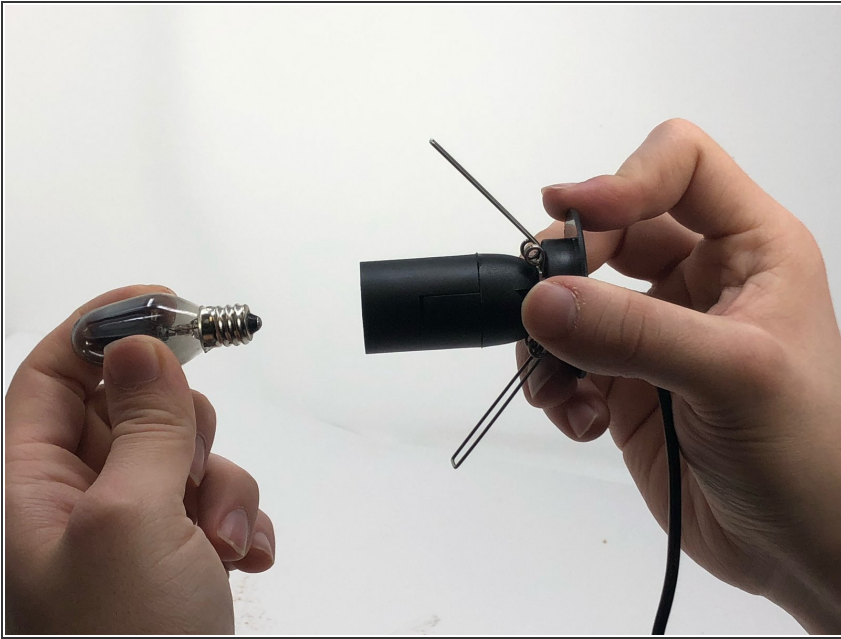

- Screw an E12 light bulb into the empty socket.
- ⓘ E12 light bulbs are 12 millimeters in diameter.

To reassemble your device, follow these instructions in reverse order.

Hopefully this fix has reinvigorated your salt lamp. Thank you for using our guide