

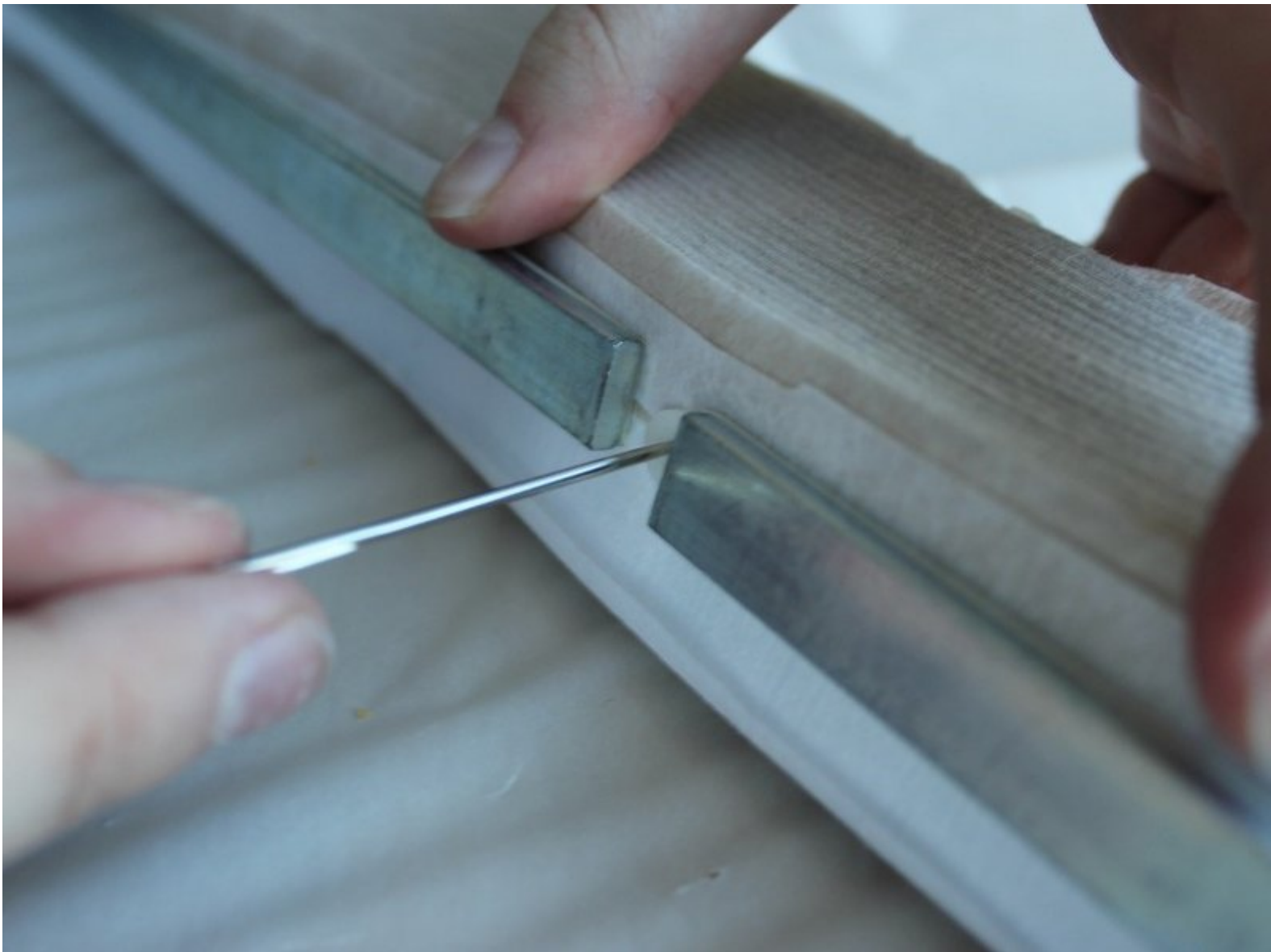

# How to Restring Cellular Shades

This guide demonstrates how to replace a broken or worn string in a cellular shade.

Written By: Tirzah Eyre



## INTRODUCTION

It is important to know how to restring cellular shades due to wear and tear from house pets, small children, and accidental damage. This guide outlines an easy repair for broken or worn strings that can be done at home instead of completely replacing the shade.



### TOOLS:

- [Flathead Screwdriver](#) (1)
  - [Tape Measure](#) (1)
  - [Utility Scissors](#) (1)
  - [Restringing Needle](#) (1)
  - [Large Needle Nose Pliers](#) (1)
  - [Phillips #1 Screwdriver](#) (1)
-

## Step 1 — Restringing Cellular Shades

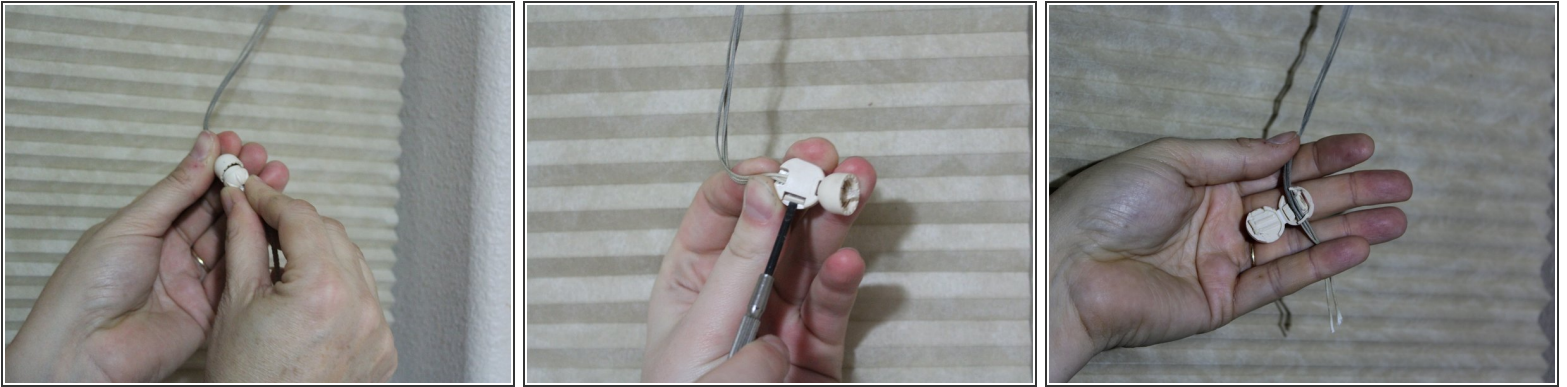

- Unscrew the tassel and set aside.
- Using a flathead screwdriver, open the cord stop, remove from the strings, and set aside.

## Step 2



- Close the shade and push up, sliding the shade out toward the center of the room.
- ⓘ This is a common method for taking down a cellular shade but not all shades are hung the same way. Use the appropriate method for your shade.
- Place the shade on a flat surface to work on.



### Step 3

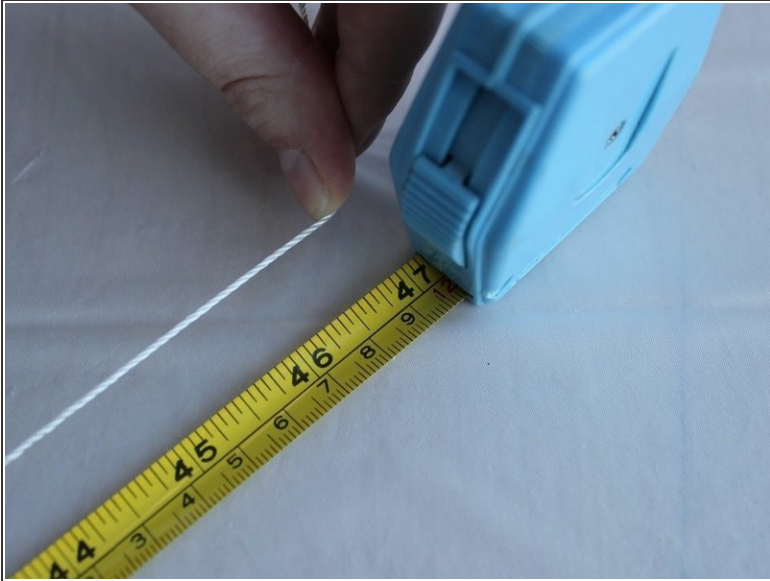

- Measure and cut the new nylon strings. To be safe, the length should be equal to the sum of the window width and twice the window height. There will be excess string and it will be cut off in step 14.

①  $\text{Length} = (\text{Window Width}) + 2 * (\text{Window Height})$

### Step 4

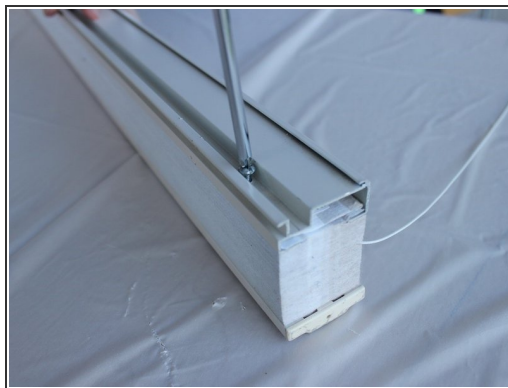

- Use the flathead screwdriver to take the end caps off of the top rail and set aside.
- Take out the screw using the Phillips screwdriver and slide the top rail off.
- Using the needle nose pliers, push the cord lock clips in from the side and slide the cord lock out, removing the strings and setting the cord lock aside.

## Step 5

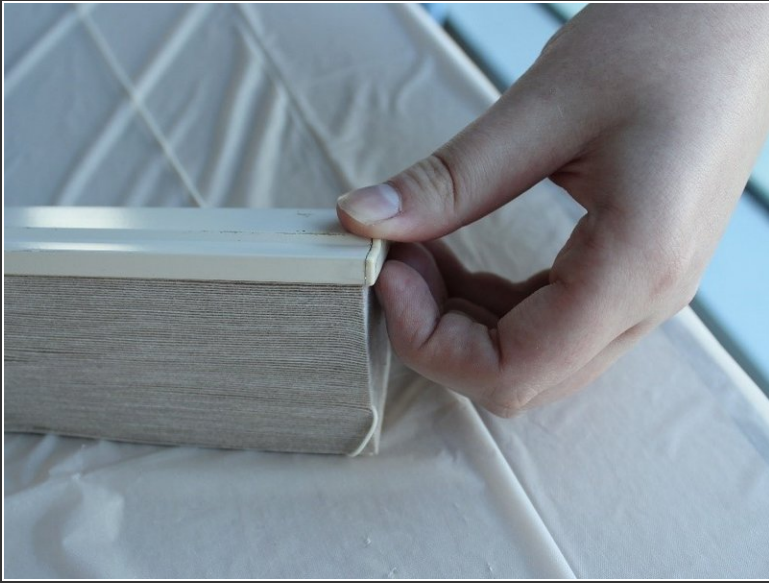

- Flip the shade over and pull the end caps off of the bottom rail. Set them aside.
- Slide the bottom rail off and set aside.

## Step 6

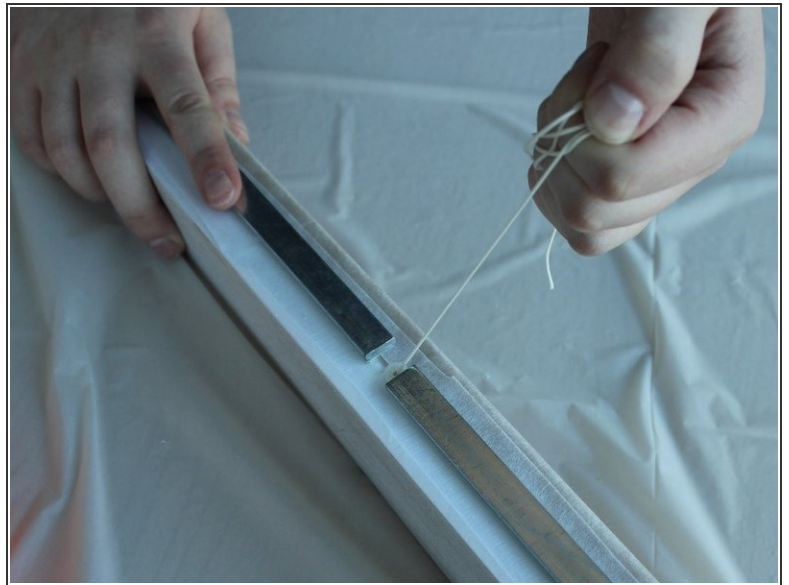
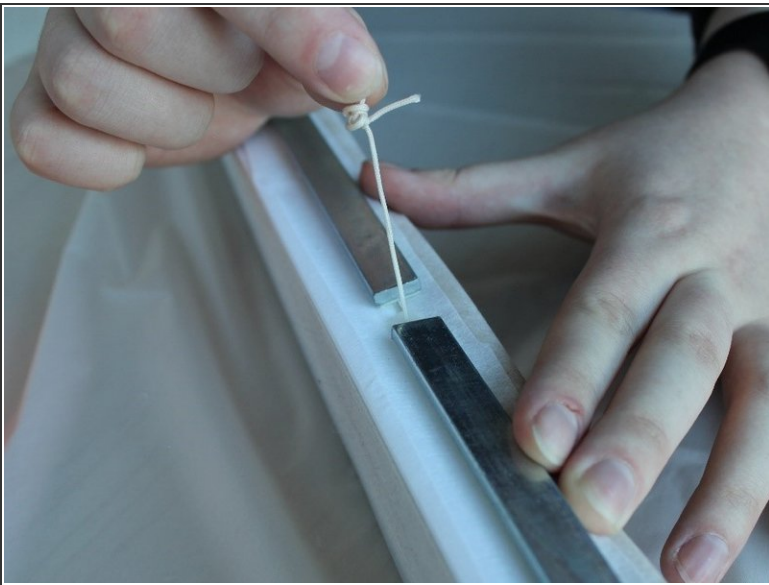

- Untie the ends of the strings between the weights on the bottom of the shade.
- Pull the strings out of the shade and discard.



## Step 7

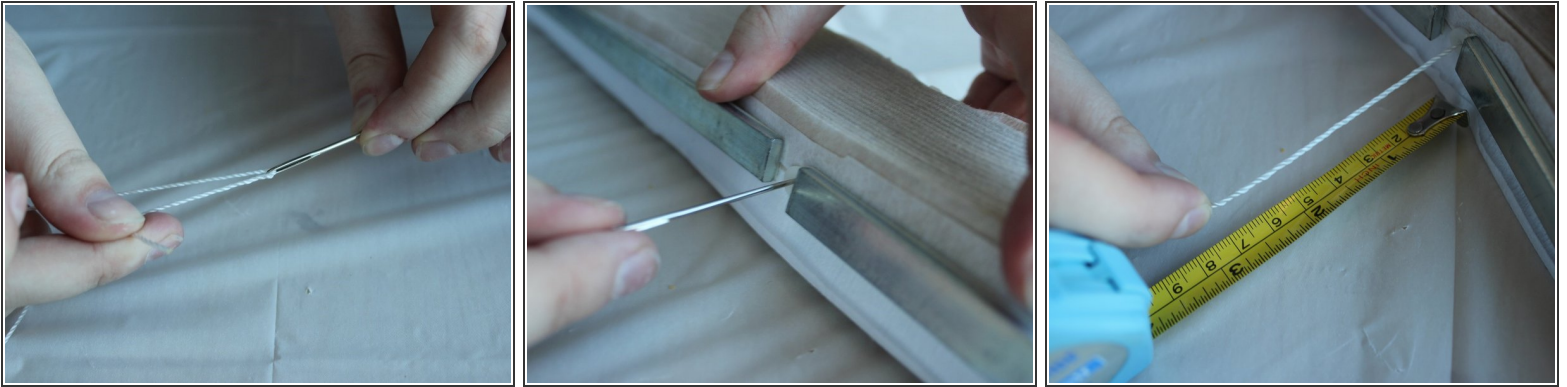

- Thread the new string through the restringing needle.
- Pull the needle and thread through the shade, making sure to leave three inches out of the bottom side of the shade.
- Repeat for the other strings.

## Step 8



- Tie a knot with the 3 inch piece and pull the string tight.
- Repeat for the other strings.

## Step 9



- Slide the bottom rail back onto the shade.
- Push the bottom end caps back onto the rail.

## Step 10

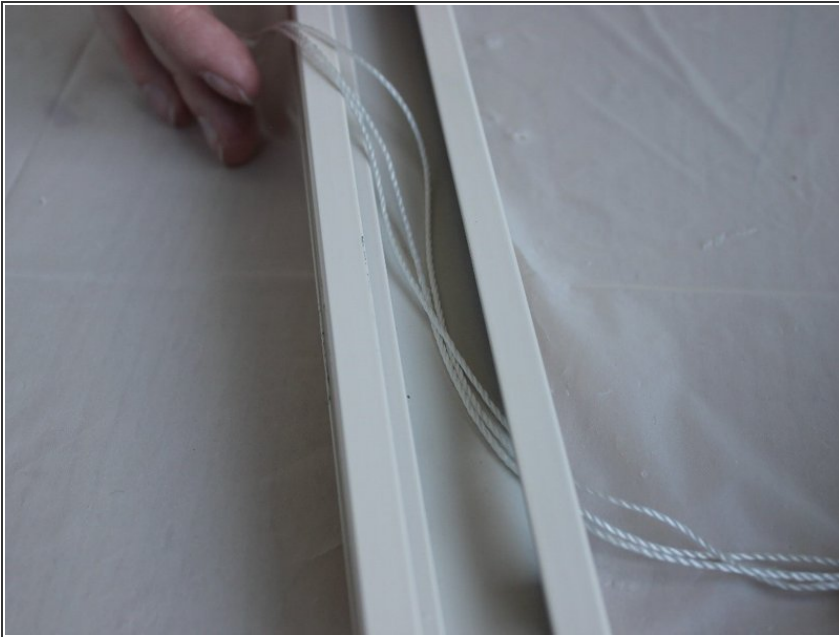

- Turn the top rail over so that the top is on the work surface.
- Thread the strings through the small gap in the top rail that the cord lock was removed from.
- ⓘ The ends of the strings should be on the outer side of the top rail.

## Step 11



- Restring the cord lock by first picking up the strings coming out of the cord lock gap. Thread them through the side opening of the cord lock and out of the back opening.
- Thread them back through the back opening and out of the front opening. Make sure to pass the strings through the black rectangular piece inside the cord lock.
- Pull the strings tight so that the strings are only in the front and side openings.

## Step 12

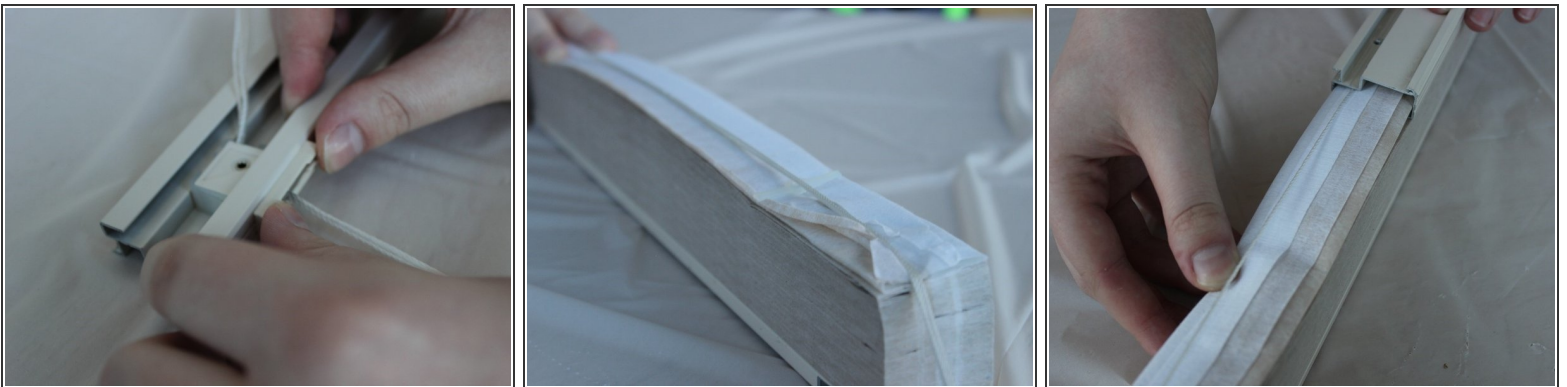

- Insert the cord lock into the gap in the top rail with the opaque plastic side facing up.
- Lay the strings down the middle of the shade.
- Slide the top rail onto the shade, pulling the strings tight through the cord lock.
- ❗ The end of the rail without the cord lock should be slid on first.



## Step 13

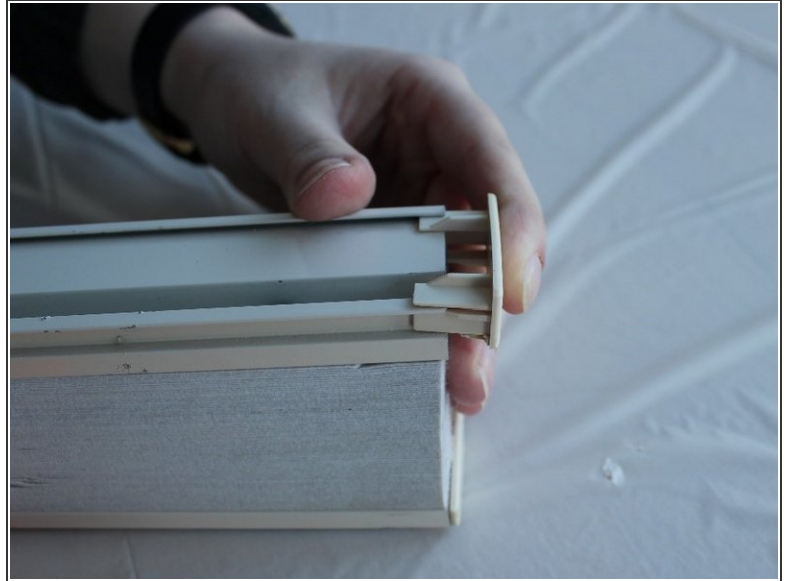

- Use the phillips screwdriver to put the screw back into the top rail.
- Push the end caps back into place.

## Step 14



- Rehang the shade by pushing the shade up into the clips and sliding it towards the window.
  - ⓘ This is a common method for rehangng cellular shades but not all shades are hung the same way. Use the appropriate method for your shade.
- Open the shade and cut the strings so the ends are halfway up the shade.

## Step 15

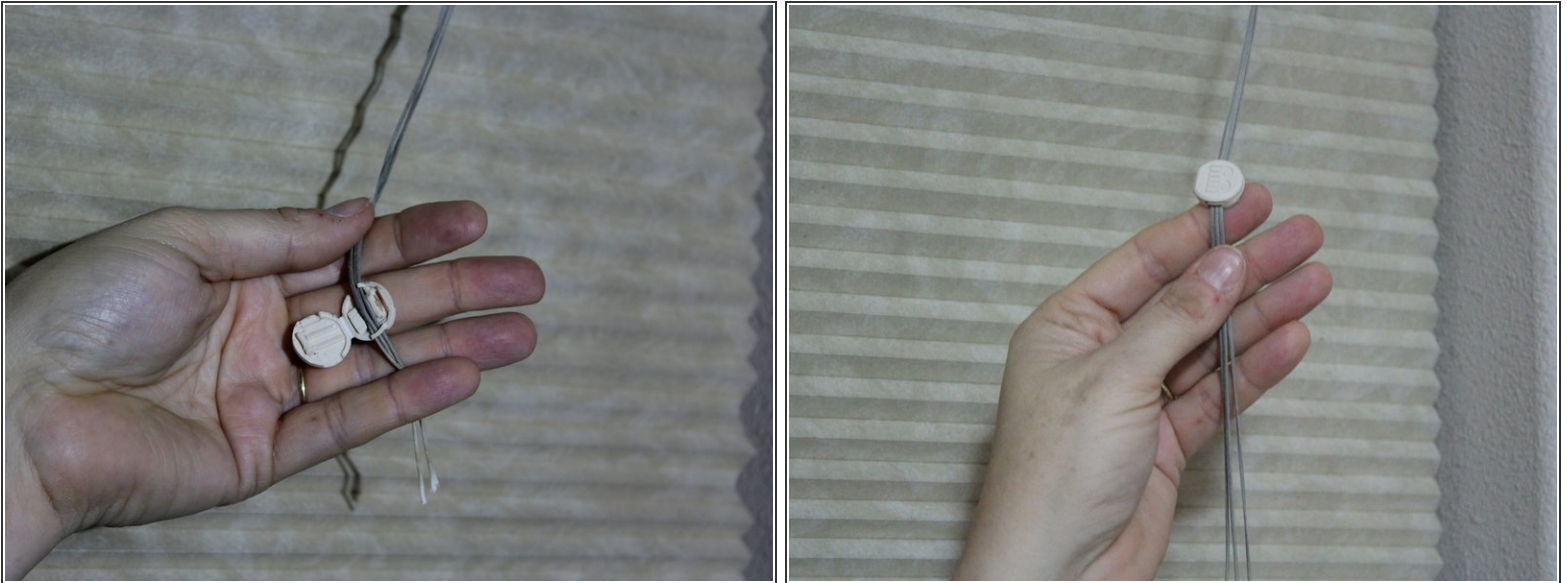

- Place the strings inside the cord stop and close it.
- Adjust the cord stop to your liking.

## Step 16



- Slide the top half of the tassel over the ends of the strings and tie the ends together.
- Screw the lower half of the tassel onto the top half.

Once you have completed the steps for restringing your cellular shade, it is ready for use. Test it out!