



Installing a Petsafe Removable Dog Panel

Installing the removable Petsafe Dog Panel into your sliding glass door.

Written By: Joshua Novello



INTRODUCTION

The Petsafe Dog Panel is a removable dog door that can be installed into the frame of your sliding glass door. Before continuing to the guide, make sure the Petsafe Dog Panel contains all the provided materials and that it is not damaged in any way. Please make sure to pay attention to the warnings before screwing into the panel or your door frame through out the installation process.



TOOLS:

- [Cordless Drill](#) (1)
- [Measuring Tape](#) (1)
- [Pencil](#) (1)
- [Phillips #0 Screwdriver](#) (1)
- [9/64" Drill bit](#) (1)

Step 1 — Petsafe Dog Panel



- Make sure you have all the tools necessary.

Step 2



- Receive your PetSafe dog door in the mail.

Step 3



- Measure the height of the sliding glass door frame.

Step 4



- Remove your lock latch from the sliding door frame.

i Lock latches may vary

Step 5



- Slide the top of your dog panel into the top track of the sliding glass door.
- Place the bottom portion of the dog panel into the bottom track of the sliding glass door.

Step 6



- Measure 12" from the top, down the side of your sliding glass door frame and mark it.
- Mark 1" above the pet flap onto the edge of your sliding glass door.

Step 7



- With a 9/64ths drill bit, drill clearance holes into the **marks made on the sliding glass door frame**
⚠ DO NOT GO THROUGH THE DOG PANEL

Step 8



- Fasten the panel to the **interior side** of the sliding glass frame with the provided 5/8" screws.
(i) MAKE SURE YOU ARE DRILLING OUTSIDE OF THE RIBBED LINE ON THE DOG PANEL.
(i) DO NOT OVERTIGHTEN.

Step 9

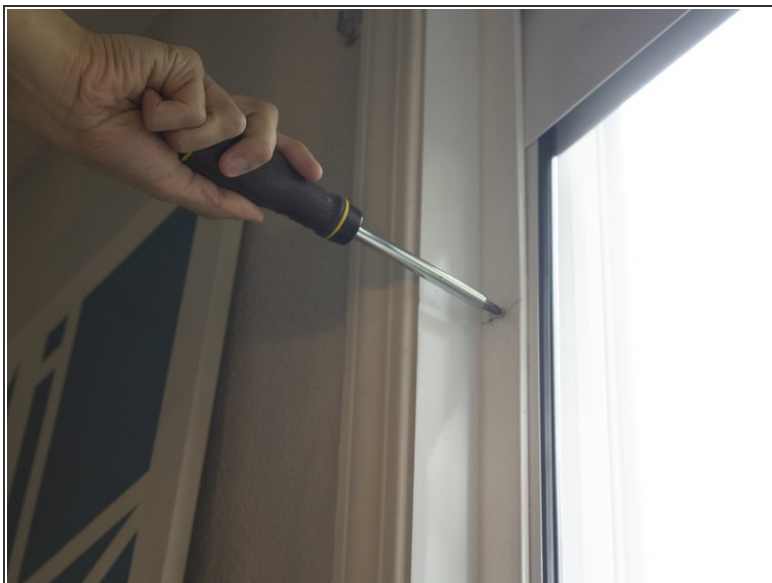

- Tighten the screws with a screwdriver.

Step 10



- Repeat steps 8 and 9 to secure the dog panel into place. Follow these steps when drilling into the clearance hole marked at the top of the frame.

Step 11



- Slide your sliding door flush against the dog door.

To reassemble your device, follow these instructions in reverse order.