



Nerf N-Strike Elite Alpha Trooper CS-12 Trigger Spring Replacement

Replace the small trigger spring.

Written By: Henrique Chan



INTRODUCTION

A damaged or missing trigger spring can prevent your rifle from firing. This guide shows you how to access and replace the small trigger spring in the Nerf N-Strike Elite Alpha Trooper CS-12.



TOOLS:

- [Phillips #0 Screwdriver](#) (1)



PARTS:

- [Compatible Replacement Spring](#) (1)

Step 1 — Notes Before Starting



- ★ There are many screws of varying lengths involved in the disassembling of this device. It is important to keep track which screws correspond to which holes. This will help ensure proper reassembly.
- Be sure that the rifle is discharged and unloaded before starting disassembly.

Step 2 — Rear Cap Removal

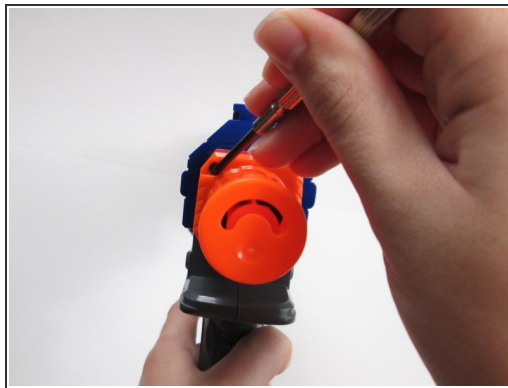

- Looking at the rear of the rifle, remove the two 10 mm phillips screws holding the orange cap to the butt of the rifle.
- Pull off the orange cap.

Step 3 — Slide Removal

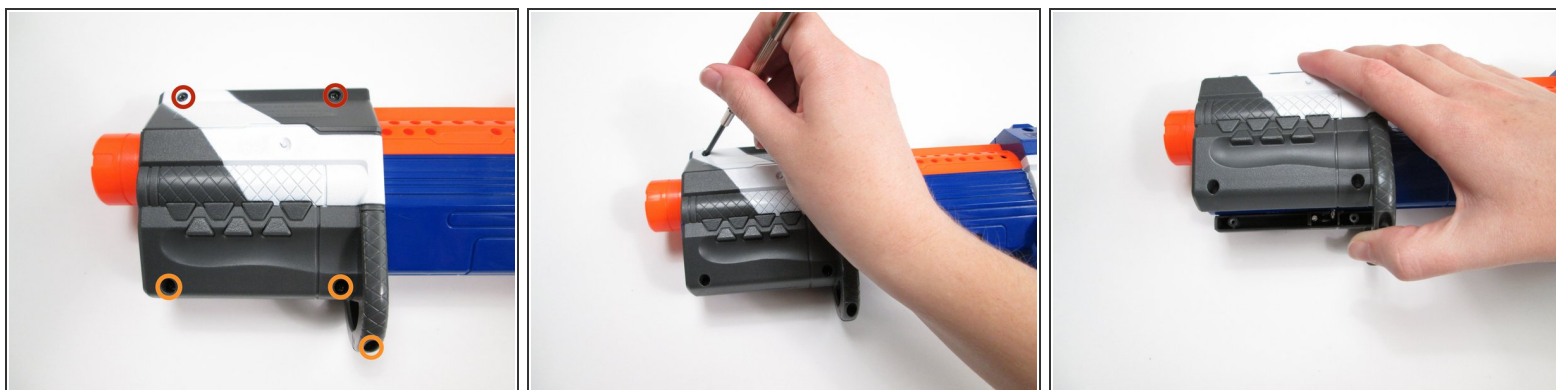

- With the rifle barrel pointing left, remove the two 8 mm phillips screws holding the slide mechanism together.
 - Remove the three 10 mm phillips screws from the bottom of the slide mechanism.
 - Remove the two halves of the slide mechanism.
- i** Make sure to keep track of which screws correspond to which holes.

Step 4



- Again with the rifle barrel pointing left, remove the fourteen 10 mm phillips screws from the main body of the rifle.
 - Remove the two 5mm phillips screws from the main body.
 - Remove the two 8 mm phillips screws from the main body.
- ⚠ Screws are varying lengths, make sure to keep track of which screws correspond to which holes.

Step 5



- Pull the two halves of the rifle apart.

⚠ Be careful of the spring at the rear end of the rifle. It may come flying out.

ⓘ If you have difficulty pulling the two halves apart, use a spudger gently pry the edges of the body apart.

⚠ Also be careful of small parts when opening the gun, they may be easy to lose.

- Remove the access gate and barrel cover.

Step 6 — Trigger Removal



- Remove the single 8mm phillips screw holding the trigger mechanism in place.
- Remove the trigger mechanism.
- Remove the small spring from the rear of the mechanism and replace it with a new spring.

To reassemble your device, follow these instructions in reverse order.