

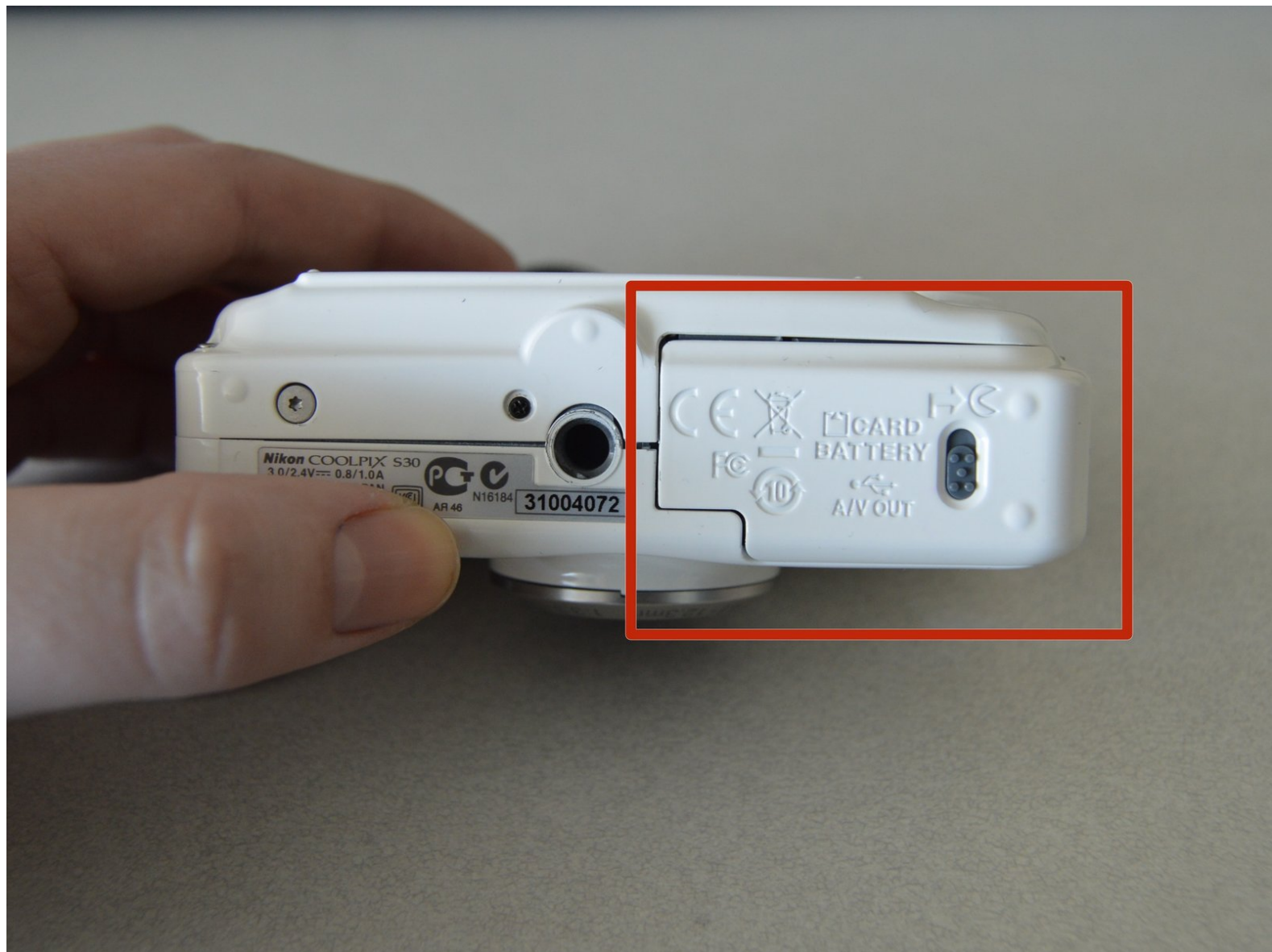

# Nikon Coolpix S30 Batteries Replacement

Replace your dead batteries to bring the power back to your camera. You will need two AA batteries.

Written By: Cassie Hamm



---

## INTRODUCTION

If your camera won't turn on you may need to replace its batteries. The only requirement for this guide is two AA batteries.



### PARTS:

- [AA Batteries](#) (2)
-

## Step 1 — Batteries

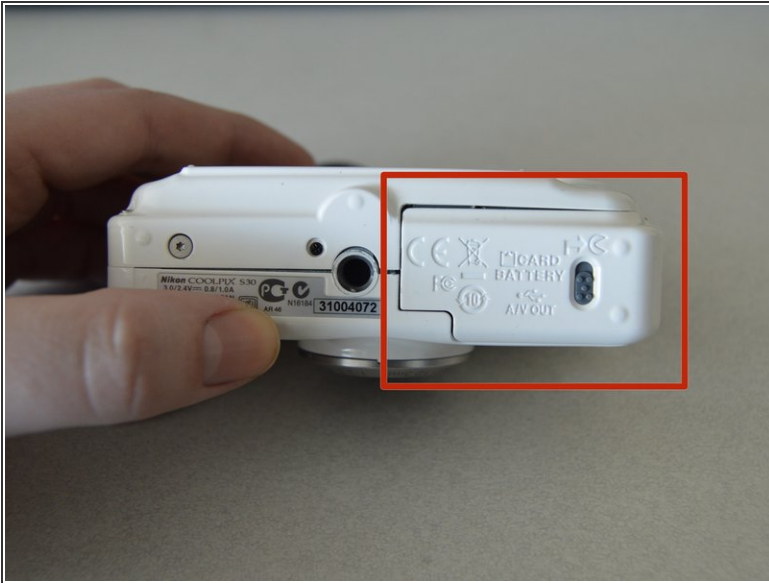

- Slide the battery cover to the right.
- The hinge is on the left side of the cover which will allow the cover to stay attached.

## Step 2



- Slide the second cover (yellow) to the right (similar to the outer cover). This will allow the batteries to be exposed.

### Step 3



- Remove the batteries by gently tipping the camera.

To reassemble your device, follow these instructions in reverse order.