



RedMax Trimmer Carburetor Replacement

Fix your RedMax trimmer by replacing the carburetor and its' gaskets.

Written By: Kevin Ydrovo



INTRODUCTION

When your trimmer fails to start after a long winter, it can be because of a number of reasons. It could be that there is no gas, the gas is tainted with water, or the spark plug is dead. If all of those are in working order, then it may be possible that the carburetor needs the gaskets replaced. The carburetor controls the amount of air entering the unit. When you engage the throttle, it allows more air to enter, causing a pressure difference, that in turn pulls more fuel from the gas tank. When the gaskets go bad, due to age, particles of debris, or water, it allows air to escape. Therefore, not enough fuel is used and the engine fails to run properly. Changing the carburetor is a simple task that can save you from taking your unit to a small engine repair shop or from buying a new one.



TOOLS:

- [T27 Screwdriver Bit](#) (1)
- [Phillips #1 Screwdriver](#) (1)



PARTS:

- [Carburetor Rebuild Kit](#) (1)

Step 1 — Carburetor



- Locate the red knob that locks the air filter cover to the air filter housing.
- Rotate the knob clockwise.
- Remove the air filter cover, exposing the air filter.

Step 2



- Remove the air filter by gently pulling it away from the unit.

Step 3



- The red panel hides a second screw. In order to expose it, locate the red choke lever on the right side of the air filter housing.
- Push the red choke lever down.

Step 4



 Be aware that there may still be gasoline in the lines.

- Disconnect the yellow and black fuel lines from the carburetor assembly by pinching the clamp and sliding it down the tube.
- Gently pull the yellow and black lines away from the assembly.

Step 5

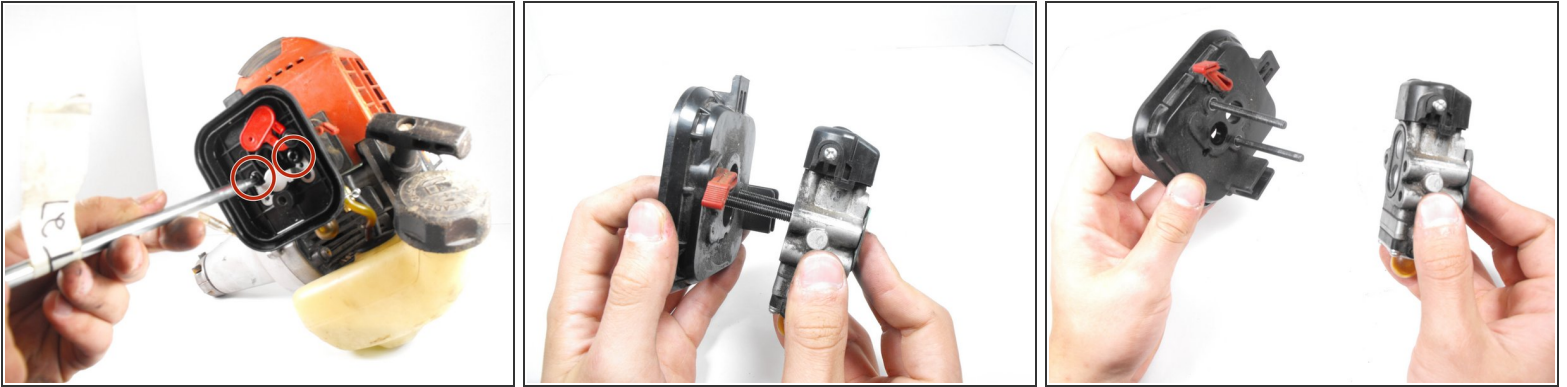

- Using the T27 screwdriver, unscrew the two 55mm screws that hold the air filter housing and carburetor to the trimmer.
- Separate the carburetor from the trimmer and air filter housing.

Step 6

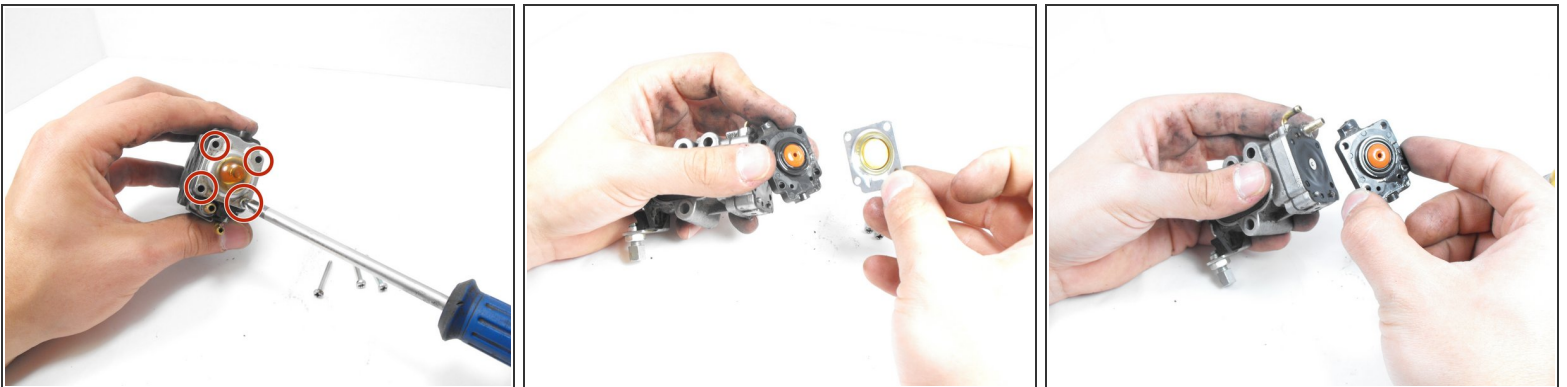

- Unscrew the four 24 mm long screws that hold the carburetor together, using the #1 Phillips head screw driver.
- Once the screws are removed, the rest of the carburetor should separate easily.

Step 7



- Carefully remove the gaskets and carburetor and replace them in the same order that they were removed.

To reassemble your device, follow these instructions in reverse order.