



# Replacing a Patagonia Wheeled Luggage Handle

Here's how to replace a jammed or stuck handle on your Patagonia Wheeled Luggage.

Written By: Brittany McCrigler



---

## INTRODUCTION

[video: <https://vimeo.com/57614687>]

The handle on your Patagonia Wheeled Luggage is designed to withstand years of hard use. But sometimes the handle becomes jammed or stuck and needs to be replaced to operate properly. Fortunately, installing a replacement handle is quick and easy.

For replacement parts or further assistance, contact [Patagonia Customer Service](#).



### TOOLS:

- [Phillips #1 Screwdriver](#) (1)

## Step 1 — Handle



- Lay your Wheeled Luggage on its back on a table.
- Unzip the main zipper.

## Step 2



- Open the main compartment of your bag until it lays flat on the table.



### Step 3



- Unzip the the zipper in the grey lining of the bag, opening the lining as you go.

### Step 4

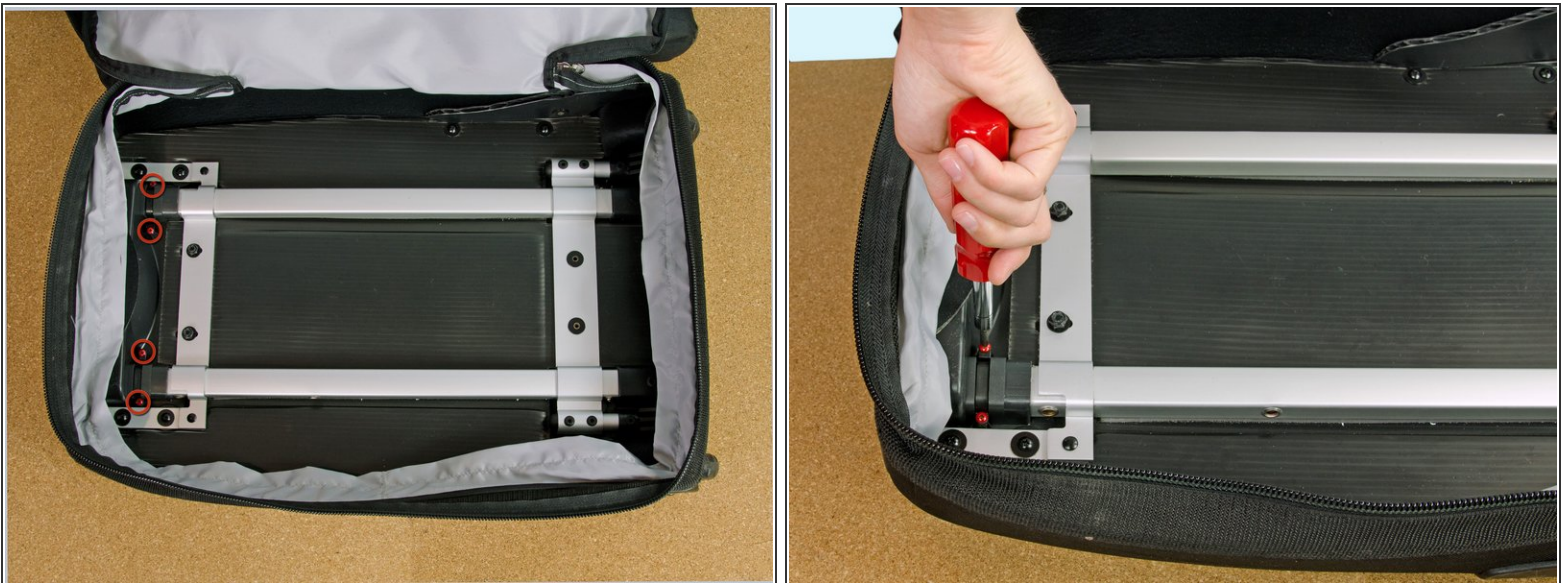

- Remove the four, red Phillips #1 screws from the frame.

## Step 5



- Remove the two black plastic retaining brackets from the frame.

## Step 6



- Depress the button on the handle by gripping firmly.

## Step 7



- With the button handle still depressed, pull the handle straight out of the bag.
- ⓘ This may require some force. If the handle doesn't come out right away you may have to pull harder.

## Step 8



- ★ When inserting a new handle, be sure to push the handle in until there is a loud click, and the brackets on the handle lay flush with the bag.



## Step 9



- If you are still having trouble with your handle, check the pins inside the bag.
  - ❗ When you depress the button on the handle, the two pins on the sides of the handle should retract, freeing the handle to slide.
- If either pin is not retracting use a pencil, screwdriver, or other thin object to push the pin into the hole.

## Step 10



- With the pin depressed, squeeze the handle and pull it from the bag.

To reassemble your device, follow these instructions in reverse order.

This document was generated on 2019-09-22 12:45:08 PM (MST).

