



Ridgid Circular Saw R3205 Blade Replacement

How to Replace the blade on a Ridgid R3205 circular saw. The blade on a circular saw is a toothed disc that cuts materials using a rotating motion.

Written By: Joshua Caron



INTRODUCTION

The blade on a circular saw is one of the most commonly replaced items. The blade wears down the quickest and needs to be replaced when the saw isn't making cuts as effectively, the blade has broken teeth, or if the blade is bent. Replacing the blade doesn't require any complicated steps.



TOOLS:

- [6 mm Hex Key](#) (1)



PARTS:

- [7 1 4in blade](#) (1)

Step 1 — Blade

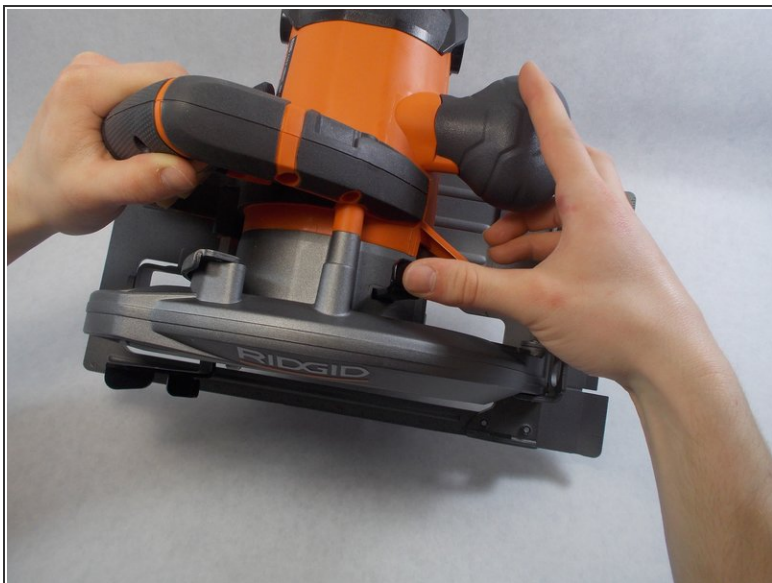

- Press the black spindle lock and hold it down.
- While keeping the spindle lock pressed down use a 6mm allen wrench to remove the 5/16-18 x 0.55 inch screw.

Step 2



- Release the spindle lock and remove the outer flange by lifting it off the output shaft.

Step 3



- With the outer flange removed retract the lower blade guard into the upper blade guard housing by pushing on the black lever.
- Slide the blade out of from the bottom of the saw.

To reassemble your device, follow these instructions in reverse order.