

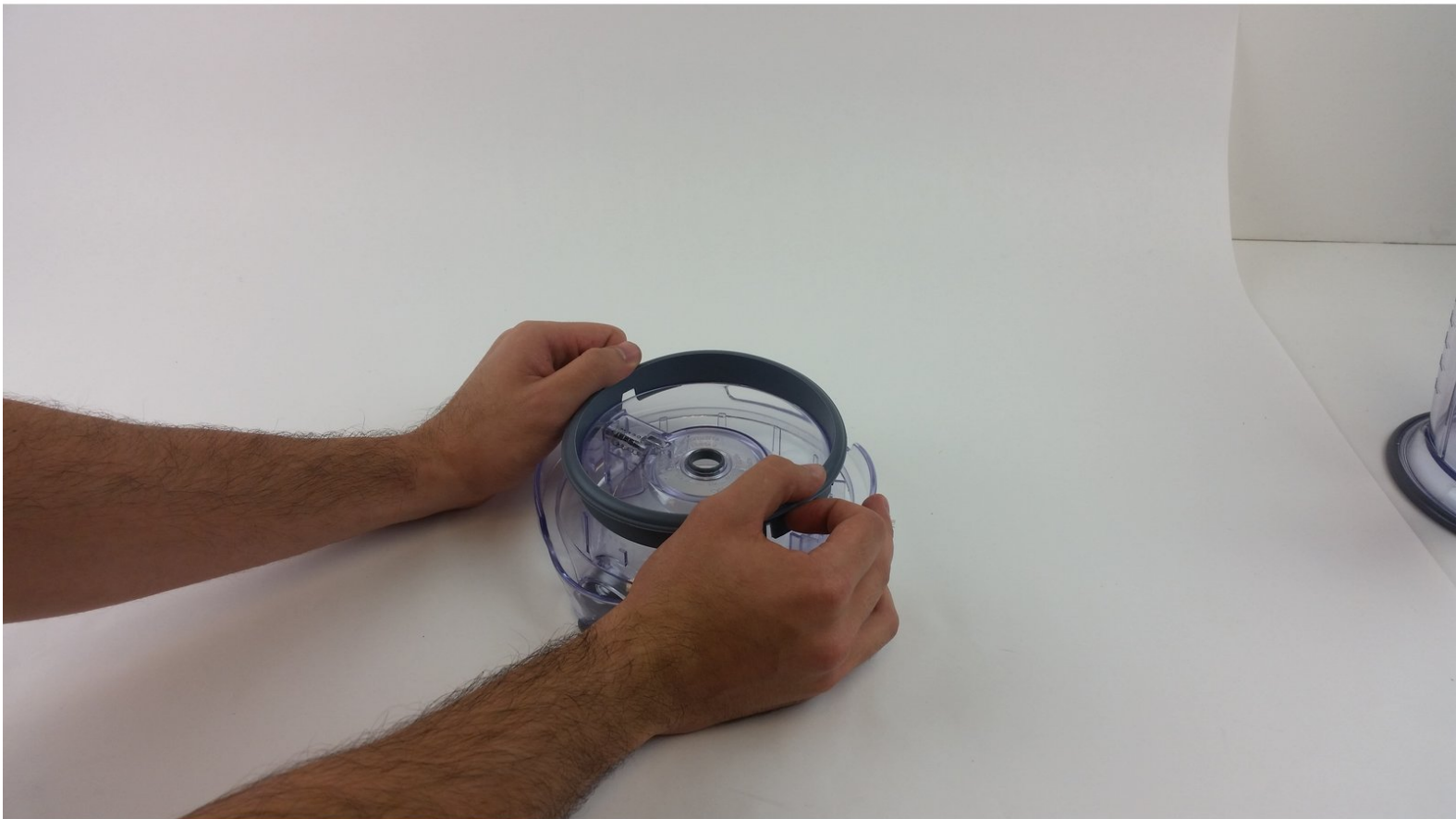

Seal Maintenance

This guide will show you how to inspect your seal, and repair or replace it.

Written By: Kamal Taha



INTRODUCTION

If your blender is leaking food the problem could be the seal on top of the cup. It could either be dislodged or torn, This guide will show you how to fix the seal if it is dislodged, and to replace it if it is torn,

Step 1 — Seal Maintenance



- Inspect your seal to see if it is loose or if there is any damage.

Step 2

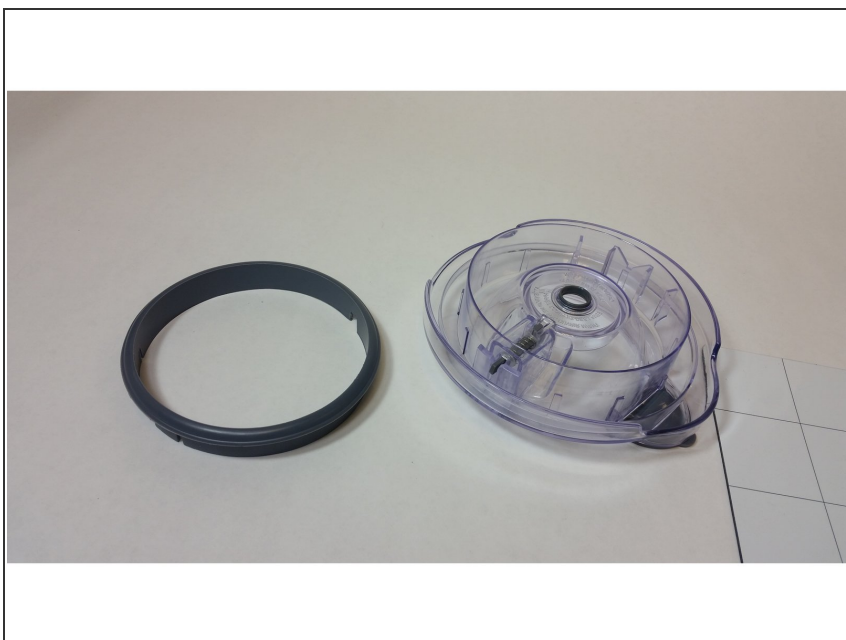

- Pull your seal off from the top.

Step 3



- Line the new seal on the grooves.

Step 4

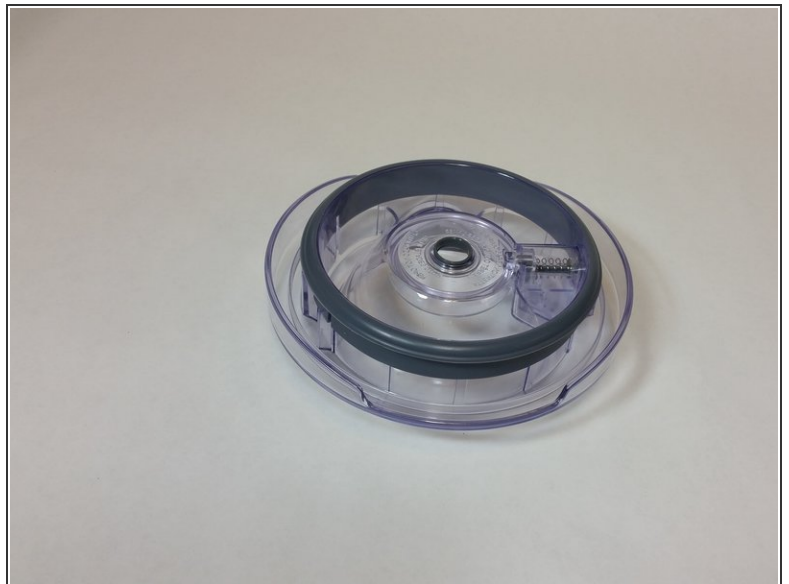

- Push down the seal until it is secured into the top.

To reassemble your device, follow these instructions in reverse order.