



Shimano Ultegra 6800 Caliper Brake Maintenance

If you want to make sure your caliper brakes are tight enough and aligned, look no further than this guide.

Written By: Leland Lam



This document was generated on 2019-09-25 08:30:04 AM (MST).

INTRODUCTION

Caliper brakes are one piece bicycle brakes that stop bicycle motion by pinching the rim with brake pads. Their main mechanism is governed by a wire that is attached to the brake levers. By using this guide to properly adjust your brakes, you can maximize brake performance.



TOOLS:

- [3mm Allen Wrench](#) (1)
 - [4mm Allen Wrench](#) (1)
 - [5mm allen wrench](#) (1)
-

Step 1 — Shimano Ultegra 6800 Caliper Brake Maintenance



- Using the 5mm allen wrench, check if the bolt on the backside of the caliper is snug.

Step 2



- If your brake caliper is still tightened, loosen the cable bolt with a 5mm Allen wrench to take tension off the caliper.

Step 3

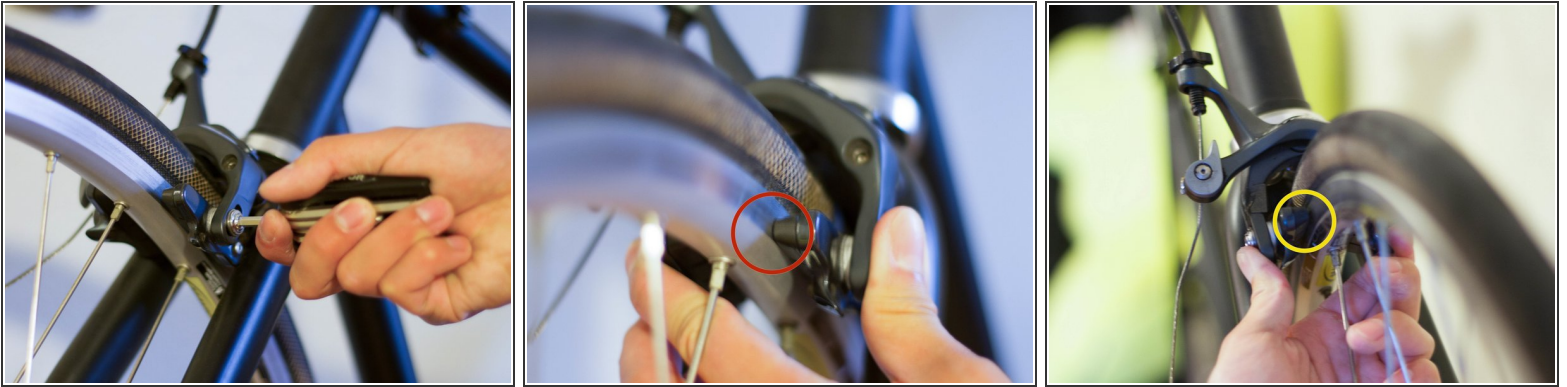

- Check if the braking pads are contacting the rim in desired locations.

i Both pads are loosened the same way.

- For the left caliper pad, marked in the red circle, loosen the bolt with a 4mm Allen wrench so the pad can be adjusted.
 - Align the bottom edge of the pad with the bottom edge of the braking surface and then tighten.
- For the right caliper pad, marked in the yellow circle, loosen the bolt with a 4mm Allen wrench so the pad can be adjusted.
 - Align the top edge of the pad with the top edge of the braking surface and then tighten.

Step 4



- Check if your brake cable is inside the groove on the two plates (marked in the red circle) that hold the brake cable.

Step 5



- If the adjustment lever is not turned down, turn it down.

Step 6



- Squeeze the caliper until both sides are about 1mm from the rim.
- While still squeezing, pull down the slack on the wire and tension the wire by bolting it down.

Step 7



- Fine tune the brake calipers by using the barrel adjuster.
- ⓘ Counter clockwise turns open the calipers and clockwise turns close the calipers.

Step 8



- Make the brake pads equidistant from the rim by adjusting the tiny bolt on top of the caliper with a 3mm Allen wrench.

Step 9



- Check if the brakes are working properly by squeezing your brake levers.

Check if your brakes are properly working before you ride. If the tightness and alignment are satisfactory, enjoy your ride.

