



# Triace A310 Disk Brake Replacement

This repair guide will demonstrate the correct way to repair or replace a disk brake.

Written By: Daniel



---

## INTRODUCTION

In order to have a safer biking experience, make sure your disk brake is properly replaced.

---



### TOOLS:

- [T25 Torx Screwdriver](#) (1)
-

## Step 1 — Tire



- Begin loosening the tire by turning the quick release handle.

## Step 2



- Gripping the rear derailleur, pull the arm back, away from the front of the bike.
- Notice how the derailleur becomes almost vertical in the second picture when compared to the first.



### Step 3



- There should be enough slack, in the chain, at this point to remove the tire from the bike.
- ⓘ Note: You may need to wiggle the tire and chain around in order to create enough slack.
- Remove the tire from the bike.

### Step 4 — Disk Brake



- Place the tire flat on the ground making sure the disk is facing you.

## Step 5

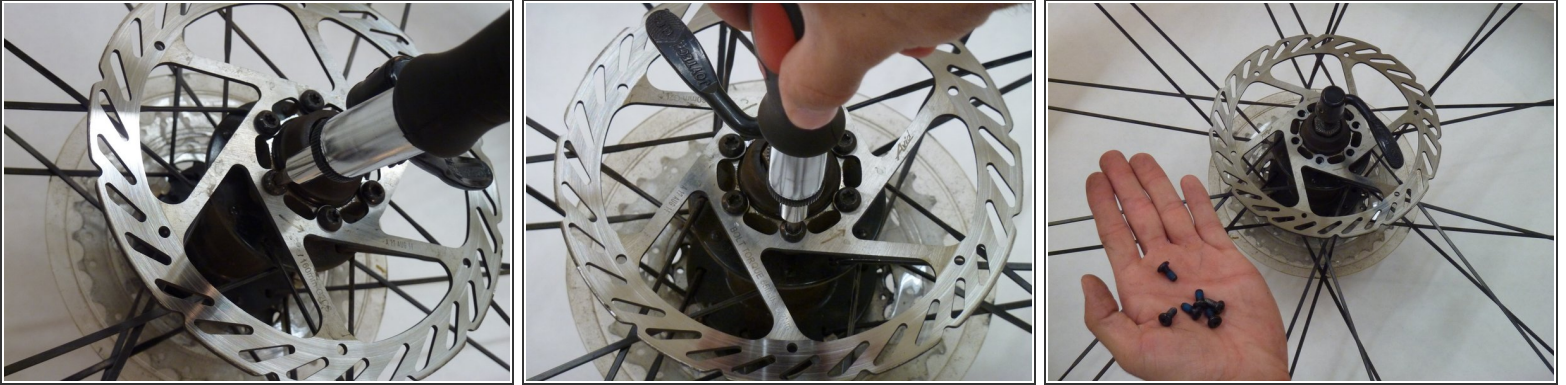

- Using the modular screw driver with a T25 bit, begin loosening and then removing the six 10mm-long screws.

☑ Make sure to keep track of all of the removed pieces.

## Step 6



- After all of the screws have been removed, take the disk and pull it away from the tire.

To reassemble your device, follow these instructions in reverse order.