



Violin Bridge Replacement

This guide will show you how to replace and adjust the bridge of a violin.

Written By: fldees



INTRODUCTION

Every violin player faces the task of changing the bridge. With very few detachable pieces on a violin, changing the bridge is one of the most essential tasks for a violin player to know. This task includes loosening the strings, removing the old bridge, prepping the new bridge with markings for strings, setting the new bridge, and retightening the strings.



TOOLS:

- [Pencil](#) (1)
- [Violin Tuner](#) (1)



PARTS:

- [Violin Bridge](#) (1)

Step 1 — Bridge

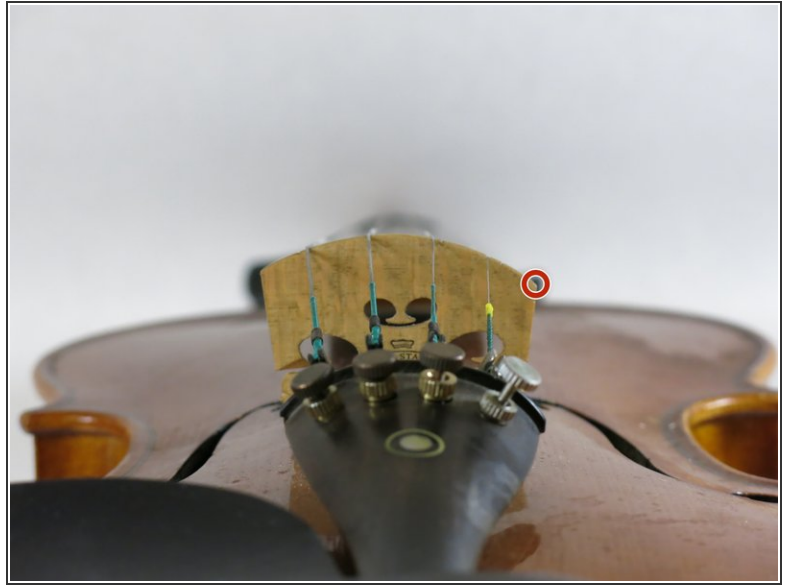

- **Identify two sides of your violin.** The violin bridge has one side that is higher than the other. The lower side is the E-string side.
 - E-string side

Step 2



- Loosen the strings gently starting with the G-string and the E-string, then the D-string and the A-string.
 - G-string
 - E-string
 - D-string
 - A-string
- ⓘ Only loosen the strings until you can easily remove the bridge from under the strings without having to drag the bridge out.

Step 3



- Remove the bridge **gently** from the violin.

Step 4



- **Mark the New bridge:** Use a pencil or other marking tool to add 4 light marks where the 4 strings sit on the top of the new bridge.
- ⓘ The width should be **wide enough** so that when you are playing on only one string the **bow won't produce noise from adjacent strings**.
- ⓘ The width should also be **narrow enough** so that, when you are playing on two strings at the same time, you can **use one finger to press on both these two strings without much difficulty**.
- ⓘ Suggested horizontal distance between adjacent strings is 9-12mm. Adjust it based on your finger width. You can also **use your old bridge as a guide** for where to make marks if you please.

Step 5

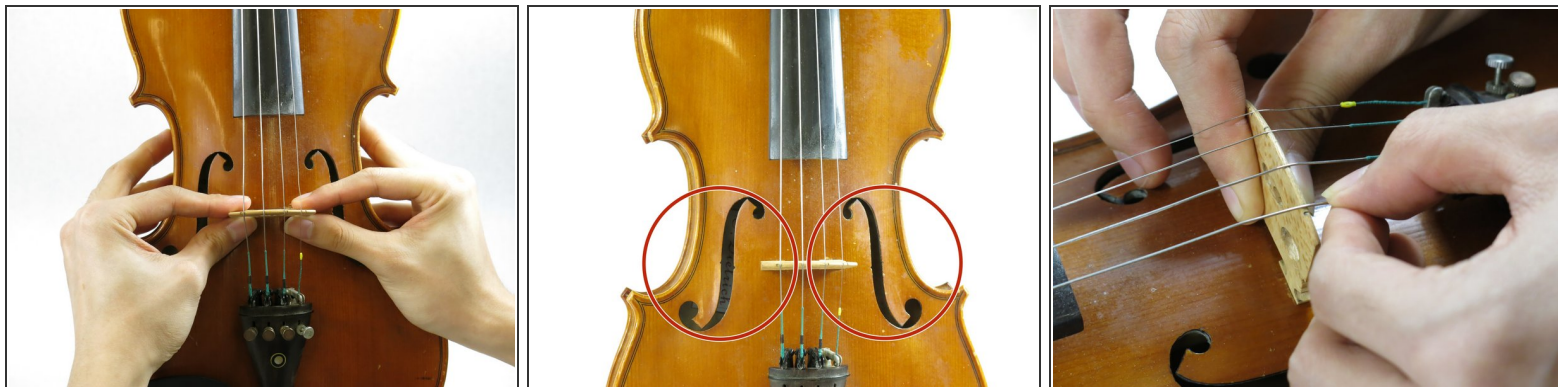

- Place the new bridge between the center of the f-holes of your violin.
 - f-holes
- Put the strings on your new bridge, align them with the marks you made in step 4.

Step 6

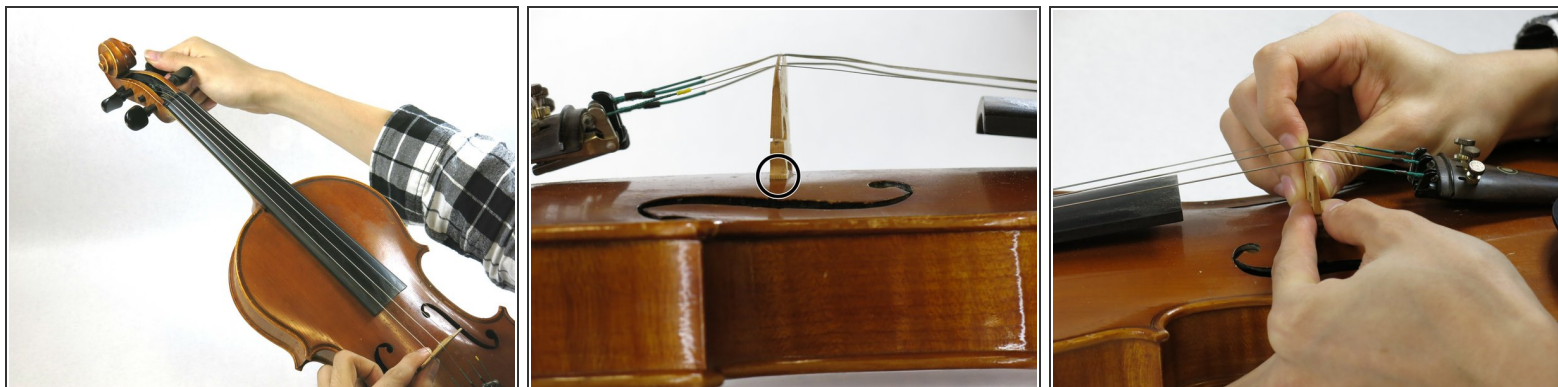

- Hold the bridge in one hand and tighten the strings in the reverse order you loosened them. That is, tighten the A-string and D-string first, and then, tighten the E-string and G-string. Tighten until each string matches its rough standard pitch (violin tuner suggested).
- ⓘ Continue to adjust the bridge to keep it perpendicular to the violin body every time you tighten the string so it is not leaning too far away from the f-holes.
- After tightening all four strings, play a little to test the string placement. **If the distance between the strings is not comfortable for performance** (as noted in step 4), **repeat step 2-6** and adjust the distance between the strings on the bridge again to find the proper distance.

Step 7



- Finally, make any last adjustments to the bridge. Ensure that it is nearly perpendicular to the violin body. Also make sure that the feet of the bridge sit flat on the body of your violin.