



Xerox C60 Fuser Replacement

This guide provides easy to understand steps for replacing the fuser on the Xerox C60.

Written By: Breanna Batdorf



INTRODUCTION

This guide helps users replace the fuser in the Xerox C60 printer. Since the fuser is important for heating the toner and making it stay on the paper, it is a vital part of the machine. Replacing the fuser can help solve some issues with the printer, though not all. Some of these issues include consistent lines on the prints made. These lines will be in the same spot each time, and have consistent color to them. Another issue that may be fixed by replacing the fuser would be consistent paper jams. With this guide, users will be able to read what to do, as well as see photos of the replacement process being done, in an easy to read and understand guide. Before replacing the fuser, users should verify that the replacement part is indeed manufactured by Xerox, as one that is not may cause irreparable damage to the printer.



PARTS:

- [Xerox C60 Fuser](#) (1)
-

Step 1 — Fuser



- Open the main printer door. This gives you access to the transfer case, which you will see in a moment.
- The handle to the main door of the printer can be located just under the blue section, on the right hand side of the printer.

Step 2

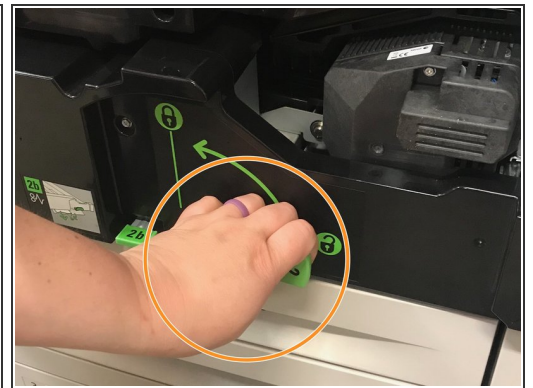
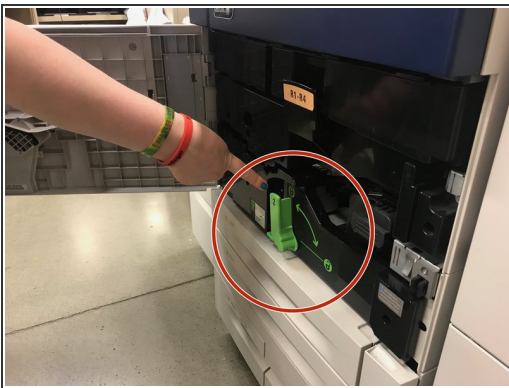

- Grasp the green handle and turn it clockwise to unlock it.
- Once the transfer case has been unlocked, it can be opened via pulling the green handle away from the machine.

Step 3



- Grab the fuser handle, ensuring that the fuser module itself is not being touched.

- ⓘ Once the transfer module has been pulled out, the fuser will be the large part that will have caution stickers on it, as well as a handle.

- ⚠ **The fuser module is HOT!! Grab the handle ONLY!!!**

- ⚠ **The fuser module may be heavy for some.** *The person completing the replacement will need roughly the same strength needed to pull the transfer case out from the printer.*

Step 4



- Grab the handle on the fuser, and lift it upward to remove it.
- Once the fuser module has been removed, set it gently on the ground, counter, or other surface that will not be affected by the heat.

Step 5

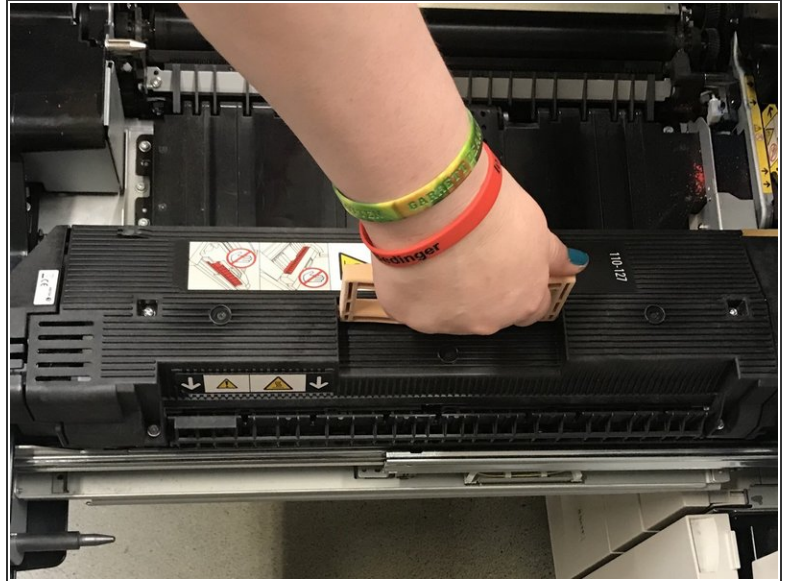

- Once the old fuser has been removed, un-package the new one, and place the new fuser in the space that the old fuser was.
- ⓘ The new fuser will not be hot like the other one, and will be safe to grab in locations other than the handle, though the handle is the easiest place to grasp.

To close the printer, simply reverse these steps.